

# REFRIGERATION BALL VALVE

## Independent development

### & One intergrated mass

Each high temperature weld may damage the inner core of the valve, however Hengsen developed a new modified process. It is to reduce a weld at the junction of copper pipe, which makes valves more immersible, safer and more beautiful.

## Easier operation convenient

### installation

Only need to turn 1/4 round to open completely from closed

With limit switch either full open or full closed



## Welding technology-high

### frequency welding

Since the current is highly concentrated in the weld area, it heats up quickly on a small area and is not easy to be oxidize to ensure a good organization and performance of the weld.

The welding surface is more uniform, beautiful and environmently friendly.

## Unimpeded access design

The pipe is unimpeded when the valve is open to connect the pipe

Valve seat fixing device can install on the stand to significantly reduce pipe vibration.



## Product Features

1. Just turn 1/4 circle to make the valve from full open to full closed, and it has rotation limitation.
2. Valve seat sealing with modified PTFE, quick on/off, seal compensation function.
3. With two-way liquidity, large flow rate, small resistance; explosion-proof valve stem design.

## Technical Data

1. Applicable medium: R22, R134a, R407C, R410a etc.
2. Applicable medium temperature:  $-30^{\circ}\text{C}$   $+$   $+120^{\circ}\text{C}$ .
3. Maximum working pressure: 4.2MPa.
4. Applicable environment temperature:  $-20^{\circ}\text{C}$   $+$   $+60^{\circ}\text{C}$ .

## Parameter Table

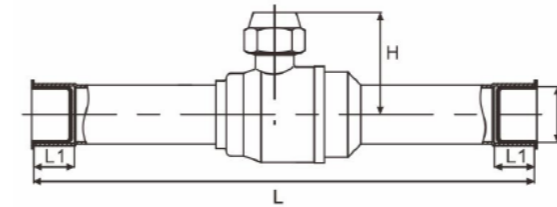

### LQF series(without charging port)

Specification	Dimension(mm)			
	D	H	L	L1
1/4	Φ6.35	35	165	7
3/8	Φ9.52	35	165	10
1/2	Φ12.7	35	165	10
5/8	Φ15.88	36.8	165	14
3/4	Φ19.1	42	180	15
7/8	Φ22.3	42.7	200	16
1	Φ25.4	42.7	200	16
1-1/8	Φ28.6	54	215	20
1-1/4	Φ31.8	54	215	20
1-3/8	Φ34.9	58.5	256	24
1-5/8	Φ41.3	68	288	25
2-1/8	Φ54	77.6	322	33
2-5/8	Φ66.7	84.5	377	35
3	Φ76.2	84.5	379	36
3-1/8	Φ79.4	84.5	377	36

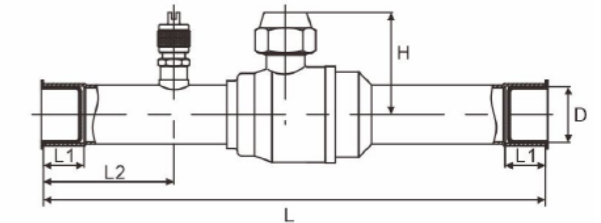

### LQF series(with charging port)

Specification	Dimension(mm)				
	D	H	L	L1	L2
1/4	Φ9.52	35	165	7	34.5
3/8	Φ9.52	35	165	10	34.5
1/2	Φ12.7	35	165	10	37
5/8	Φ15.88	36.8	165	14	37
3/4	Φ19.1	42	180	15	40.5
7/8	Φ22.3	42.7	200	16	51
1	Φ25.4	42.7	200	16	51
1-1/8	Φ28.6	54	215	20	52
1-1/4	Φ31.8	54	215	20	52
1-3/8	Φ34.9	58.5	256	24	67
1-5/8	Φ41.3	68	288	25	77
2-1/8	Φ54	77.6	322	33	78
2-5/8	Φ66.7	84.5	377	35	108
3	Φ76.2	84.5	379	36	95
3-1/8	Φ79.4	84.5	377	36	96