

# User Manual

## Onground Lighting

Please read user manual before commencing installation and keep it for future reference.

### ■WARNING.

- 1.The safety of this lighting fixture is guaranteed only if you comply with these instructions.
2. Don't connect these lighting fixtures to the mains supply directly, and please use the specific proper driver with specific input voltage.
3. The driver must be electronic switching power supply with constant voltage output,must not be magnetic transformer.
4. Please disconnect the power before repair, installation or replacement.
5. Please use these fixtures in the proper application places as to avoid the lights be broken.
6. Do not locate fixtures in low areas where water will collect.
- 7.If any questions on this instruction, please consult a professional qualified technicians.

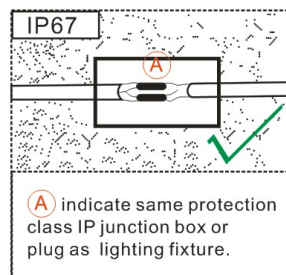
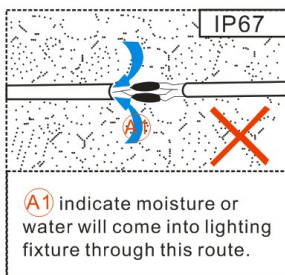

### ■Instructions of installation.

- 1.Ensure mains supply is switched off during the whole installation period.
  - 2.Please check below drawing “I”, make the holes for the cable gland with  $\phi 20\text{mm}$  diameter at min. Also drill holes for the Screw embedded parts.
  - 3.Feed the cables through the hole of the mounting base and pre-drilled hole on ground, mount the mounting base part with provided screws onto the ground surface as drawing “II”, “III”.
  - 4.Push the the lamp body directly on the mounting part until it snaps into position as drawing “IV”, in this way the silicone o-ring can lock the lamp body on the mounting part tightly together.
- Use the IP67 or IP68 waterproof connector to connect the cables of the fixture and the cables of specific driver in parallel circuit.
- Ensure everything is installed very well, and then turn on the power for the illumination application.

I

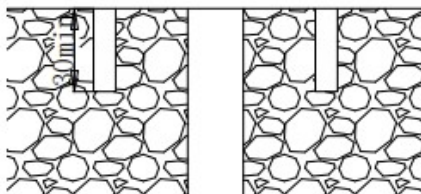
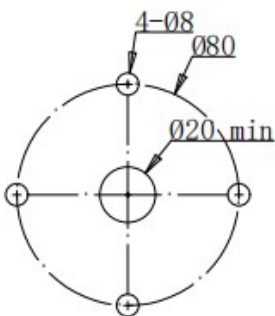

II

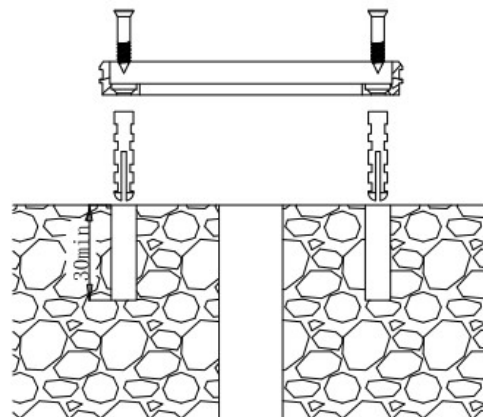

III

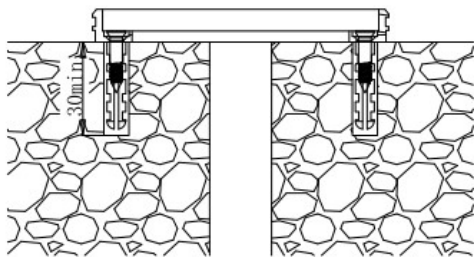

IV

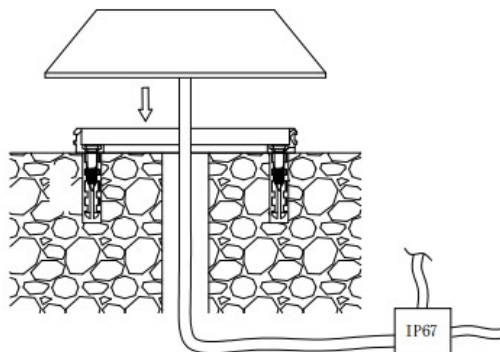

### ■Specifications.

Item No.: UL-D001-0600-I2

Input: DC12V-DC24V

Power: 6W

IP rating: IP67

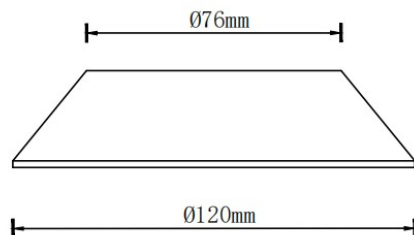

29mm

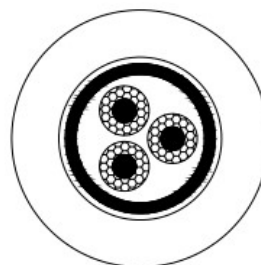

Warning.

The non-professionals can not disassemble or repair the fixture. We keep the right to refuse the replacement or repairing of the fixtures that have been disassembled or repaired personally.