



陕西飞晨建筑科技有限公司

开拓创新 | 品质卓越 | 诚信服务
Pioneering Innovation | Excellent Quality | Honest Service

MAIN PRODUCTS

主营产品



▶ **双翼拓展房**
EXPANDABLE FOLDING CONTAINER HOUSE



▶ **创意集装箱**
CREATIVE CONTAINER HOUSE



▶ **折叠式箱房**
FOLDING CONTAINER HOUSE



▶ **太空舱**
SPACE CAPSULE



▶ **装配式箱房**
PREFAB FLAT PACK CONTAINER HOUSE



▶ **苹果舱**
APPLE CABIN

▶ **度假屋**
VACATION HOUSE



产品外观
PRODUCT EXTERIOR



产品布局
PRODUCT LAYOUT



20尺1室2厅
20 FEET, 1 BEDROOM, 2 LIVING ROOMS



20尺2室2厅
20 FEET, 2 BEDROOMS, 2 LIVING ROOMS



40尺2室2厅
40 FEET, 2 BEDROOMS, 2 LIVING ROOMS



40尺3室2厅
40 FEET, 3 BEDROOMS, 2 LIVING ROOMS



30尺1室2厅
30 FEET, 1 BEDROOM, 2 LIVING ROOMS



30尺2室2厅
30 FEET, 2 BEDROOMS, 2 LIVING ROOMS



产品内饰

INTERNAL DECORATION OF THE PRODUCT



一室两厅

ONE BEDROOM, TWO LIVING ROOMS



两室两厅

TWO BEDROOMS, TWO LIVING ROOMS



两室两厅(主卧)

TWO BEDROOMS, TWO LIVING ROOMS (MASTER BEDROOM)



两室两厅(次卧)

TWO BEDROOMS, TWO LIVING ROOMS (SIDE BEDROOM)



厨房布局
KITCHEN LAYOUT



卫生间
BATHROOM



产品骨架图

PRODUCT SKELETON DIAGRAM

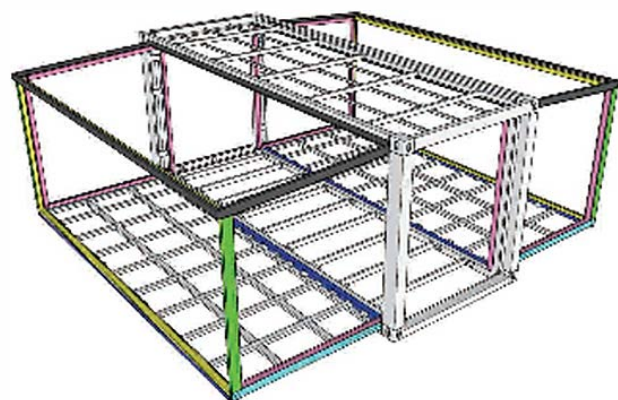

10尺双翼

10 FEET EXPANDABLE FOLDING CONTAINER HOUSE

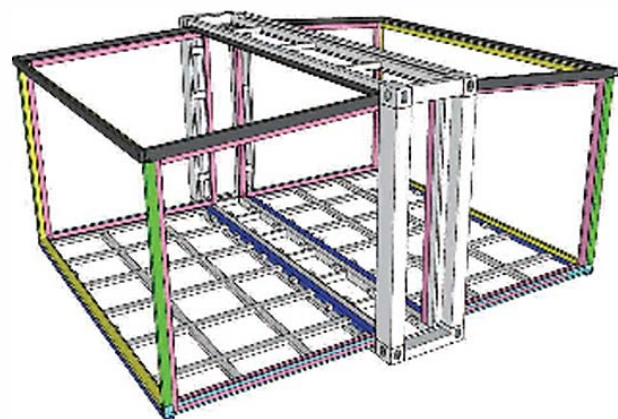

20尺缩小版双翼

LITTLE 20 FEET EXPANDABLE FOLDING CONTAINER HOUSE

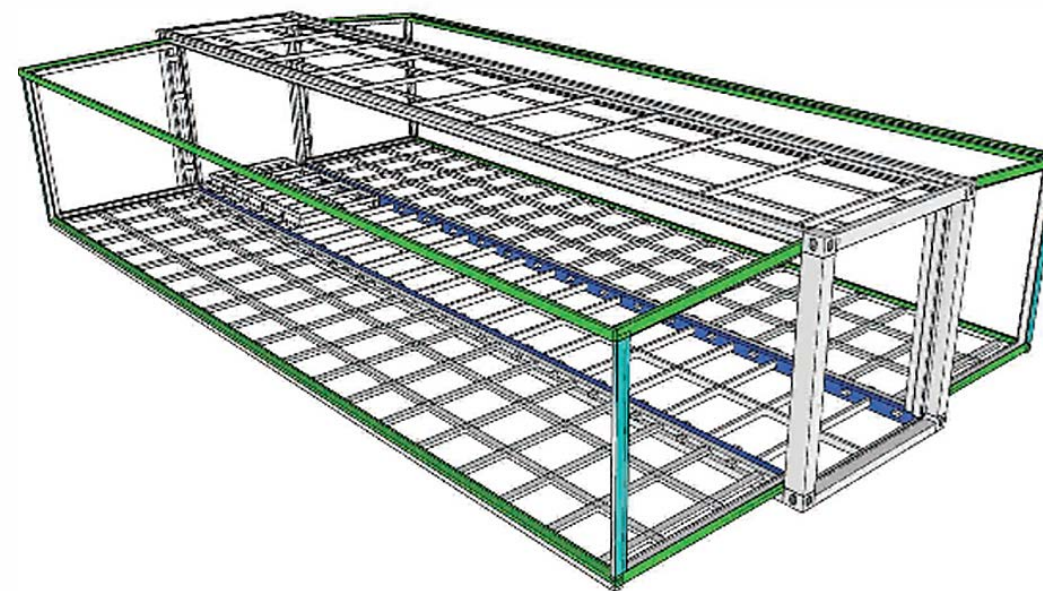

40尺双翼

40 FEET EXPANDABLE FOLDING CONTAINER HOUSE

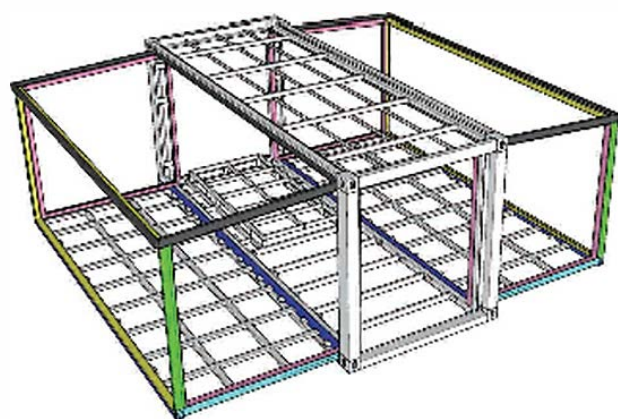

20尺双翼

20 FEET EXPANDABLE FOLDING CONTAINER HOUSE

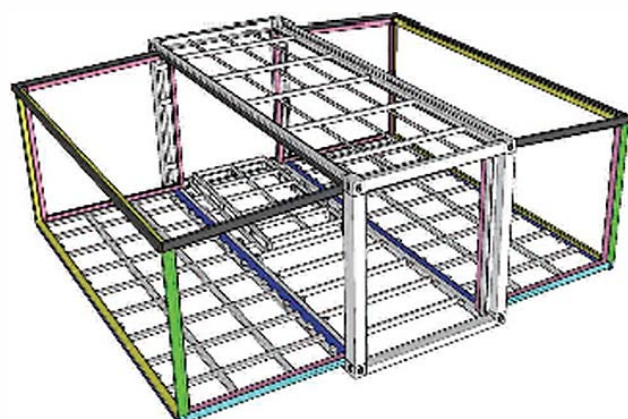

30尺双翼

30 FEET EXPANDABLE FOLDING CONTAINER HOUSE

安装步骤

INSTALLATION STEPS



产品参数

PRODUCT PARAMETERS

10尺双翼配置参数

基本特征	产品型号	10尺小双翼	户型	一厅
	拓展尺寸	L2950*W6300*H2480	入住人数	2~4人
	内部尺寸	L2510*W6140*H2240	用电功率	12KW
	折叠尺寸	L2950*W2200*H2480	总净重量	1.6吨
	占地面积	18.5㎡		
框架结构				
名称	内容	规格		
主框架 (全镀锌)	顶侧梁	80*100*2.5mm方管		
	顶端梁	折弯件 2.0mm		
	底侧梁	80*100*2.5mm方管		
	底端梁	折弯件 2.0mm		
	镀锌吊头	镀锌吊头210*150*160		
	钢立柱	折弯件 2.0mm		
侧翼框架 (全镀锌)	顶框架	40*80*1.5mm P形管		
		40*80*1.5mm方管		
	底框架	60*80*2.0mm 方管		
	折叠合页	130mm镀锌合页		
整体框架保护涂料	喷涂	静电喷塑/百白塑粉		
箱顶	外部顶板	t50mm EPS彩钢板+瓦楞单板t0.4mm		
	内部吊顶板	200型吊顶板		
墙板	侧墙、前后	t65mm EPS彩钢板		
	内隔断板	t50mm EPS彩钢板		
地面	主框	防火水泥纤维地板 18mm厚		
	两翼	竹胶板 18mm厚		
门窗	塑钢推拉窗	920*920mm		
	钢制单开门	840*2030mm		
电气系统	断路器系统	32A漏电保护器1个, 电压220V, 50HZ		
	灯	公牛30*30平板灯、大吸顶灯		
	插座	标配国际三孔、五孔插座 (可根据客户要求配置插座标准)		
	灯开关	双开, 单键开关 (可根据客户要求配置开关标准)		
	配线	进线6², 空调插座4², 普通插座2.5², 照明1.5²。 (可根据国别定制符合认证要求电路)		
装箱数量	40尺高柜装4套			

10 feet expandable folding container house configuration parameters

Basic feature	Product model	10 feet	House type	One Hall
	Expanded size	L2950*W6300*H2480	Number of people accommodated	2-4 people
	Internal dimensions	L2510*W6140*H2240	Power consumption	12KW
	Folded Size	L2950*W2200*H2480	Total net weight	1.6 tons
	Floor area	18.5㎡		
Frame structure				
Name	Content	Specifications		
Main frame (fully galvanized)	Top side beam	80*100*2.5mm square tube		
	Top beam	Bending parts 2.0mm		
	Bottom side beam	80*100*2.5mm square tube		
	Bottom beam	Bending parts 2.0mm		
	Galvanized hanging head	Galvanized hanging head 210*150*160		
Side frame (fully galvanized)	Steel column	Bending parts 2.0mm		
	Top frame	40*80*1.5mm P-shaped tube		
	Bottom frame	40*80*1.5mm Square tube		
	Folding hinge	60*80*2.0mm Square tube		
Overall framework protective coating	Spray	130mm Galvanized hinge		
Roof	External top plate	Electrostatic spray molding/straight white plastic powder		
	Internal ceiling panels	T50mm EPS color steel plate+corrugated veneer t0.4mm		
Wallboard	Side walls, front and rear	200 type ceiling panel		
	Inner partition board	T65mm EPS color steel plate		
Ground	Center floor	T50mm EPS color steel plate		
	Floor on both sides	18mm thick fireproof cement fiber floor		
Doors and windows	Plastic steel sliding window	Bamboo plywood 18mm thick		
	Steel single door	920*920mm		
Electrical system	Circuit breaker system	840*2030mm		
	Light	One 32A leakage protector, Voltage 220V, 50HZ		
	Socket	Bulb 30*30 flat lamp, large ceiling lamp		
	Light Switch	Standard international three hole and five hole sockets (socket standards can be configured according to customer requirements)		
	Wiring	Double open, single key switch (switch standard can be configured according to customer requirements)		
Loading Quantity	Incoming Line 6², Air conditioning socket 4², Ordinary socket 2.5², Lighting 1.5². (Circuit that meets certification requirements can be customized according to the country)			
	1 40HQ shipping container can hold 4 sets.			

20尺缩小版双翼配置参数

基本特征	产品型号	20尺小双翼	户型	一厅
	拓展尺寸	L5900*W4800*H2480	入住人数	2~4人
	内部尺寸	L5460*W4640*H2240	用电功率	12KW
	折叠尺寸	L5900*W700*H2480	总净重量	1.95吨
	占地面积	27.5m ²		
框架结构				
名称	内容	规格		
主框架 (全镀锌)	顶侧梁	80*100*2.5mm方管		
	顶端梁	折弯件 2.0mm		
	底侧梁	80*100*2.5mm方管		
	底端梁	折弯件 2.0mm		
	镀锌吊头	镀锌吊头210*150*160		
	钢立柱	折弯件 2.0mm		
侧翼框架 (全镀锌)	顶框架	40*80*1.5mm P形管		
		40*80*1.5mm方管		
	底框架	60*80*2.0mm 方管		
	折叠合页	130mm镀锌合页		
整体框架保护涂料	喷涂	静电喷塑/富白塑粉		
箱顶	外部顶板	t50mm EPS彩钢板+瓦楞单板t0.4mm		
	内部吊顶板	200型吊顶板		
墙板	侧墙、前后	t65mm EPS彩钢板		
	内隔断板	t50mm EPS彩钢板		
地面	主框	防火水泥纤维地板 18mm厚		
	两翼	竹胶板 18mm厚		
门窗	塑钢推拉窗	920*920mm		
	钢制单开门	840*2030mm		
电气系统	断路器系统	32A漏电保护器1个, 电压220V, 50HZ		
	灯	公牛30*30平板灯、大吸顶灯		
	插座	标配国际三孔、五孔插座 (可根据客户要求配置插座标准)		
	灯开关	双开、单键开关 (可根据客户要求配置开关标准)		
	布线	进线6 ² , 空调插座4 ² , 普通插座2.5 ² , 照明1.5 ² . (可根据国别定制符合认证要求电路)		
装柜数量	40尺高柜装6套			

Little 20 feet downsized version expandable folding container house configuration parameters

Basic feature	Product model	Little 20 feet	House type	One Hall
	Expanded size	L5900*W4800*H2480	Number of people	2-4 people
	Internal dimensions	L5460*W4640*H2240	Power consumption	12KW
	Folded Size	L5900*W700*H2480	Total net weight	1.95 tons
	Floor area	27.5m ²		
Frame structure				
Name	Content	Specifications		
Main frame (fully galvanized)	Top side beam	80*100*2.5mm square tube		
	Top beam	Bending parts 2.0mm		
	Bottom side beam	80*100*2.5mm square tube		
	Bottom beam	Bending piece 2.0mm		
	Galvanized hanging head	Galvanized hanging head 210*150*160		
	Steel column	Bending piece 2.0mm		
Side frame (fully galvanized)	Top frame	40*80*1.5mm P-shaped pipe		
		40*80*1.5mm square tube		
	Bottom frame	60*80*2.0mm square tube		
	Folding hinge	130mm galvanized hinge		
Overall framework protective coating	Spray	Electrostatic spray molding/straight white plastic powder		
Roof	External top plate	T50mm EPS color steel plate+corrugated veneer t0.4mm		
	Internal ceiling panels	200 type ceiling panel		
Wallboard	Side walls, front and rear	T65mm EPS color steel plate		
	Inner partition board	T50mm EPS color steel plate		
Ground	Center floor	18mm thick fireproof cement fiber floor		
	Floor on both sides	Bamboo plywood 18mm thick		
Doors and windows	Plastic steel sliding window	920*920mm		
	Steel single door	840*2030mm		
Electrical system	Circuit breaker system	One 32A leakage protector, Voltage 220V, 50HZ		
	Light	Bull 30 * 30 flat lamp, large ceiling lamp		
	Socket	Standard international three hole and five hole sockets (socket standards can be configured according to customer requirements)		
	Light Switch	Double open, single key switch (switch standard can be configured according to customer requirements)		
Wiring	Incoming Line 6 ² , Air conditioning socket 4 ² , Ordinary socket 2.5 ² , Lighting 1.5 ² . (Circuit that meets certification requirements can be customized according to the country)			
Loading Quantity	1 40HQ shipping container can hold 6 sets.			

20尺双翼配置参数

基本特征	产品型号	20尺双翼	户型	一厅
	拓展尺寸	L5900*W6300*H2480	入住人数	2-4人
	内部尺寸	L5460*W6140*H2240	用电功率	12KW
	折叠尺寸	L5900*W2200*H2480	总净重量	2.8吨
	占地面积	37㎡		
框架结构				
名称	内容	规格		
主框架 (全镀锌)	顶侧梁	Φ0*100*2.5mm方管		
	顶端梁	折弯件 2.0mm		
	底侧梁	Φ0*100*2.5mm方管		
	底端梁	折弯件 2.0mm		
	镀锌吊头	镀锌吊头210*150*160		
	钢立柱	折弯件 2.0mm		
侧翼框架 (全镀锌)	顶框架	40*80*1.5mm P形管		
		40*80*1.5mm方管		
	底框架	60*80*2.0mm 方管		
	折叠合页	130mm镀锌合页		
整体框架保护涂料	喷涂	静电喷塑/直白塑粉		
箱顶	外部顶板	t50mm EPS彩钢板 + 瓦楞单板t0.4mm		
	内部吊顶板	200型吊顶板		
墙板	侧墙、前后	t65mm EPS彩钢板		
	内隔断板	t50mm EPS彩钢板		
地面	主楼	防火水泥纤维地板 18mm厚		
	两侧	竹胶板 18mm厚		
门窗	塑钢推拉窗	920*920mm		
	钢制门	840*2030mm		
电气系统	断路器系统	32A漏电保护器1个, 电压220V, 50HZ		
	灯	公牛30*30平板灯、大吸顶灯		
	插座	标配国际三孔、五孔插座 (可根据客户要求配置插座标准)		
	灯开关	双开, 单键开关 (可根据客户要求配置开关标准)		
	配线	进线6², 空调插座4², 普通插座2.5², 照明1.5²。 (可根据国别定制符合认证要求电路)		
装柜数量	40尺高柜装2套			

20 feet expandable folding container house configuration parameters

Basic feature	Product model	20 feet	House type	One Hall
	Expanded size	L5900*W6300*H2480	Number of people accommodated	2-4 people
	Internal dimensions	L5460*W6140*H2240	Power consumption	12KW
	Folded Size	L5900*W2200*H2480	Total net weight	2.8 tons
	Floor area	37㎡		
Frame structure				
Name	Content	Specifications		
Main frame (fully galvanized)	Top side beam	Φ0*100*2.5mm Square tube		
	Top beam	Bending parts 2.0mm		
	Bottom side beam	Φ0*100*2.5mm Square tube		
	Bottom beam	Bending parts 2.0mm		
	Galvanized hanging head	Galvanized hanging head 210*150*160		
	Steel column	Bending parts 2.0mm		
Side frame (fully galvanized)	Top frame	40*80*1.5mm P-shaped tube		
		40*80*1.5mm Square tube		
	Bottom frame	60*80*2.0mm Square tube		
	Folding hinge	130mm Galvanized hinge		
Overall framework protective coating	Spray	Electrostatic spray molding/straight white plastic powder		
Roof	External top plate	T50mm EPS color steel plate + corrugated veneer t0.4mm		
	Internal ceiling panels	200 type ceiling panel		
Wallboard	Side walls, front and rear	T65mm EPS color steel plate		
	Inner partition board	T50mm EPS color steel plate		
Ground	Center floor	18mm thick fireproof cement fiber floor		
	Floor on both sides	Bamboo plywood 18mm thick		
Doors and windows	Plastic steel sliding window	920*920mm		
	Steel single door	840*2030mm		
Electrical system	Circuit breaker system	One 32A leakage protector, Voltage 220V, 50HZ		
	Light	Bull 30*30 flat lamp, large ceiling lamp		
	Socket	Standard international three hole and five hole sockets (socket standards can be configured according to customer requirements)		
	Light Switch	Double open, single key switch (switch standard can be configured according to customer requirements)		
	Wiring	Incoming Line 6², Air conditioning socket 4², Ordinary socket 2.5², Lighting 1.5², (Circuit that meets certification requirements can be customized according to the country)		
Loading Quantity	1 40HQ shipping container can hold 2 sets.			

30尺双翼配置参数

基本特征	产品型号	30尺双翼	户型	一厅
	拓展尺寸	L9000*W6220*H2480	入住人数	3-6人
	内部尺寸	L8540*W6060*H2240	用电功率	12KW
	折叠尺寸	L9000*W2200*H2480	总净重量	3.75吨
	占地面积	56㎡		
框架结构				
名称	内容	规格		
主框架 (全镀锌)	顶侧梁	80*140*3.0mm方管		
	顶端梁	折弯件 2.5mm		
	底侧梁	80*140*3.0mm方管		
	底端梁	折弯件 2.5mm		
	镀锌吊头	镀锌吊头210*150*160		
	钢立柱	折弯件 2.5mm		
侧翼框架 (全镀锌)	顶框架	40*80*1.5mm P形管		
		40*80*1.5mm方管		
	底框架	60*80*2.5mm 方管		
	折叠合页	130mm镀锌合页		
整体框架保护涂料	喷涂	静电喷涂/直白塑粉		
箱顶	外部顶板	t50mm EPS彩钢板 + 瓦楞单板t0.4mm		
	内部吊顶板	200型吊顶板		
墙板	侧墙、前后	t65mm EPS彩钢板		
	内隔断板	t50mm EPS彩钢板		
地面	主框	防火水泥纤维地板 18mm厚		
	两侧	竹胶板 18mm厚		
门窗	塑钢推拉窗	920*920mm		
	钢制门	840*2030mm		
电气系统	断路器系统	32A漏电保护器1个, 电压220V, 50HZ		
	灯	公牛30*30平板灯、大吸顶灯		
	插座	标配国际三孔、五孔插座 (可根据客户要求配置插座标准)		
	灯开关	双开, 单键开关 (可根据客户要求配置开关标准)		
	配线	进线6², 空调插座4², 普通插座2.5², 照明1.5²。 (可根据国别定制符合认证要求电路)		
装柜数量	40尺高柜装1套			

30 feet expandable folding container house configuration parameters

Basic feature	Product model	30 feet	House type	One Hall
	Expanded size	L9000*W6220*H2480	Number of people accommodated	3-6 people
	Internal dimensions	L8540*W6060*H2240	Power consumption	12KW
	Folded Size	L9000*W2200*H2480	Total net weight	3.75 tons
	Floor area	56㎡		
Frame structure				
Name	Content	Specifications		
Main frame (fully galvanized)	Top side beam	80*140*3.0mm Square tube		
	Top beam	Bending parts 2.5mm		
	Bottom side beam	80*140*3.0mm Square tube		
	Bottom beam	Bending parts 2.5mm		
	Galvanized hanging head	Galvanized hanging head 210*150*160		
	Steel column	Bending parts 2.5mm		
Side frame (fully galvanized)	Top frame	40*80*1.5mm P-shaped tube		
		40*80*1.5mm Square tube		
	Bottom frame	60*80*2.5mm Square tube		
	Folding hinge	130mm Galvanized hinge		
Overall framework protective coating	Spray	Electrostatic spray; molding/straight white plastic powder		
Roof	External top plate	t50mm EPS color steel plate+corrugated veneer t0.4mm		
	Internal ceiling panels	200 type ceiling panel		
Wallboard	Side walls, front and rear	t65mm EPS color steel plate		
	Inner partition board	t50mm EPS color steel plate		
Ground	Center floor	18mm thick fireproof cement fiber floor		
	Floor on both sides	Bamboo plywood 18mm thick		
Doors and windows	Plastic steel sliding window	920*920mm		
	Steel single door	840*2030mm		
Electrical system	Circuit breaker system	One 32A leakage protector, Voltage 220V, 50HZ		
	Light	Bull 30*30 flat lamp, large ceiling lamp		
	Socket	Standard international three hole and five hole sockets (socket standards can be configured according to customer requirements)		
	Light Switch	Double open, single key switch (switch standard can be configured according to customer requirements)		
	Wiring	Incoming Line 6², Air conditioning socket 4², Ordinary socket 2.5², Lighting 1.5². (Circuit that meets certification requirements can be customized according to the country)		
Loading Quantity	1 40HQ shipping container can hold 1 sets.			

40尺双翼配置参数

基本特征	产品型号	40尺双翼	户型	一厅
	拓展尺寸	L11800*W6220*H2480	入住人数	3~6人
	内部尺寸	L11540*W6060*H2240	用电功率	12KW
	折叠尺寸	L11800*W2200*H2480	总净重量	4.6吨
	占地面积	72m ²		
框架结构				
名称	内容	规格		
主框架 (全镀锌)	顶侧梁	80*140*3.0mm方管		
	顶端梁	折弯件 2.5mm		
	底侧梁	80*140*3.0mm方管		
	底端梁	折弯件 2.5mm		
	镀锌吊头	镀锌吊头210*150*160		
	钢立柱	折弯件 2.5mm		
侧翼框架 (全镀锌)	顶框架	40*80*1.8mm P形管		
		40*80*1.8mm方管		
	底框架	60*80*2.5mm 方管		
	折叠合页	130mm镀锌合页		
整体框架保护涂料	喷涂	静电喷塑/直白塑粉		
箱顶	外部顶板	t50mm EPS彩钢板 + 瓦楞单板t0.4mm		
	内部吊顶板	200型吊顶板		
墙板	侧墙、前后	t65mm EPS彩钢板		
	内隔断板	t50mm EPS彩钢板		
地面	主框	防火水泥纤维地板 18mm厚		
	两翼	竹胶板 18mm厚		
门窗	塑钢推拉窗	920*920mm		
	钢制门	840*2030mm		
电气系统	断路器系统	32A漏电保护器1个, 电压220V,50HZ		
	灯	公牛30*30平板灯、大吸顶灯		
	插座	标配国际三孔、五孔插座 (可根据客户要求配置插座标准)		
	灯开关	双开, 单键开关 (可根据客户要求配置开关标准)		
	配线	进线6 ² , 空调插座4 ² , 普通插座2.5 ² , 照明1.5 ² . (可根据国别定制符合认证要求电路)		
配件	包含顶角线、踢脚线、包角、防水胶带、吊带、结构胶、胶枪			
装柜数量	40尺高柜装1套			

40 feet expandable folding container house configuration parameters

Basic feature	Product model	40 feet	House type	One Hall
	Expanded size	L11800*W6220*H2480	Number of people accommodated	3~6人
	Internal dimensions	L11540*W6060*H2240	Power consumption	12KW
	Folded Size	L11800*W2200*H2480	Total net weight	4.6 tons
	Floor area	72m ²		
Frame structure				
Name	Content	Specifications		
Main frame (fully galvanized)	Top side beam	80*140*3.0mm square tube		
	Top beam	Bending parts 2.5mm		
	Bottom side beam	80*140*3.0mm square tube		
	Bottom beam	Bending parts 2.5mm		
	Galvanized hanging head	Galvanized hanging head 210*150*160		
	Steel column	Bending parts 2.5mm		
Side frame (fully galvanized)	Top frame	40*80*1.8mm P-shaped tube		
		40*80*1.8mm Square tube		
	Bottom frame	60*80*2.5mm Square tube		
	Folding hinge	130mm Galvanized hinge		
Overall framework protective coating	Spray	Electrostatic spray molding/straight white plastic powder		
Roof	External top plate	T50mm EPS color steel plate+corrugated veneer t0.4mm		
	Internal ceiling panels	200 type ceiling panel		
Wallboard	Side walls, front and rear	t65mm EPS color steel plate		
	Inner partition board	t50mm EPS color steel plate		
Ground	Center floor	18mm thick fireproof cement fiber floor		
	Floor on both sides	Bamboo plywood 18mm thick		
Doors and windows	Plastic steel sliding window	920*920mm		
	Steel single door	840*2030mm		
Electrical system	Circuit breaker system	One 32A leakage protector. Voltage 220V, 50HZ		
	Light	Bull 30*30 flat lamp, large ceiling lamp		
	Socket	Standard international three hole and five hole sockets (socket standards can be configured according to customer requirements)		
	Light Switch	Double open, single key switch (switch standard can be configured according to customer requirements)		
	Wiring	Incoming Line 6 ² , Air conditioning socket 4 ² , Ordinary socket 2.5 ² , Lighting 1.5 ² . (Circuit that meets certification requirements can be customized according to the country)		
Accessory	Including top corner line, skirting line, corner wrapping, waterproof tape, sling, structural adhesive, and glue gun			
Loading Quantity	1 40HQ shipping container can hold 1 sets.			

产品介绍 PRODUCT INTRODUCTION

利用风能和太阳能资源互补性的新能源发电系统，结合蓄电池做储能装置的技术，提供房内家用电器日常使用且将多余电能储存起来并供应夜间使用，如夜间或阴雨天气可用风力发电，微风与光源均可发电，无需外接电源（有外接电源口），智能切换节能模式。

A new energy generation system that utilizes the complementary resources of wind and solar energy, combined with the technology of using batteries as energy storage devices, provides daily use of household appliances in the room and stores excess energy for nighttime use. At night or cloudy and rainy weather, wind power can be used to generate electricity, and both breeze and light sources can generate electricity without the need for an external power source (with an external power port), intelligently switching energy-saving modes.



太阳能控制器与逆变器一体机
SOLAR CONTROLLER AND INVERTER INTEGRATED MACHINE



储电箱
ENERGY STORAGE BOX



配电箱
DISTRIBUTION BOX



风力发电控制器
WIND POWER GENERATION CONTROLLER

配置设施：风力发电机(300W垂直轴)，太阳能光伏板(330W*18块，总容量5094W)，储能箱（5000W磷酸铁锂电池可充电），5000W太阳能控制器与逆变器一体机。

适应场景：边远牧区、无电源地区、海岛、景区民宿等。

Configuration facilities: wind turbine (300W vertical axis), solar photovoltaic panels (330W * 18 pieces, total capacity 5094W), energy storage box (5000W lithium iron phosphate battery rechargeable), 5000W solar controller and inverter integrated machine.

Adaptation scenarios: remote pastoral areas, areas without power supply, islands, scenic homestays, etc.

产品外观 PRODUCT EXTERIOR



二层平顶双翼

TWO STORY FLAT TOP EXPANDABLE FOLDING CONTAINER HOUSE



产品内饰/布局

PRODUCT INTERIOR DECORATION/LAYOUT



产品骨架图

PRODUCT SKELETON DIAGRAM

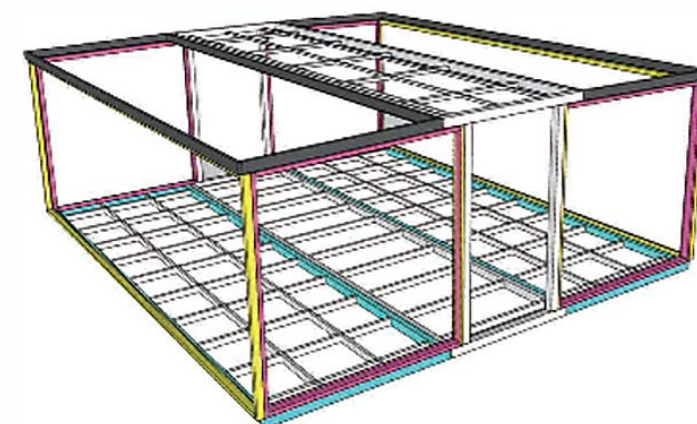

产品参数

PRODUCT PARAMETERS

20尺平顶双翼配置参数

产品型号	20尺平顶双翼	户型	一厅
拓展尺寸	L5900*W6420*H2450	入住人数	2-4人
内部尺寸	L5740*W6260*H2250	用电功率	12KW
折叠尺寸	L5900*W2200*H2450	总净重量	3.1吨
占地面积	38m ²		
框架结构			
序号	名称	内容	规格
1	主框架 (镀锌)	顶侧梁	80*100*3.0mm方管外包2.0折弯件
2		顶端梁	80*100*3.0mm方管外包2.0折弯件
3		底侧梁	80*100*3.0mm方管外包2.0折弯件
4		底端梁	80*100*3.0mm方管外包2.0折弯件
5		吊头	12.8钢便携防脱吊钩
6		钢立柱	80*100*3.0mm方管外包2.0折弯件
7	侧翼框架 (镀锌)	顶框架	50*100*2.5mm方管外包2.0折弯件
8			40*80mm*1.8mmP型管
9		底框架	80*100*3.0mm 方管外包2.0折弯件
10		折叠合页	130mm镀锌合页
11	整体框架保护涂料	喷涂	静电喷塑/自白粉
12	箱顶	主体外部顶板	t50mm EPS彩钢瓦 + 瓦楞单板t0.4mm
13		侧翼外部顶板	t100mm EPS彩钢瓦 + 瓦楞单板t0.4mm
14		内部吊顶板	200型吊顶板
15	墙板	侧墙、前后	t65mm EPS彩钢瓦
16		内隔断板	t50mm EPS彩钢瓦
17	地面	主框	防火水泥纤维地板 18mm厚
18		两翼	竹胶板 18mm厚
19	门窗	塑钢推拉窗	920*920mm
20		钢制门	840*2030mm
21	电气系统	断路器系统	32A漏电保护器1个。电压220V,50HZ
22		灯	公牛30*30平板灯、大吸顶灯
23		插座	标配国际三孔、五孔插座 (可根据客户要求配置插座标准)
24		灯开关	双开、单键开关 (可根据客户要求配置开关标准)
25		配线	进线6 ² , 空调插座4 ² , 普通插座2.5 ² , 照明1.5 ² 。(可根据国别定制符合认证要求电路)
26	配件	包含顶角线、踢脚线、包角、防水胶带、吊带、结构胶、胶枪	

20 feet flat top expandable folding container house configuration parameters

Product model	20 feet	House type	One Hall
Expanded size	L5900*W6420*H2450	Number of people accommodated	2-4 people
Internal dimensions	L5740*W6260*H2250	Power consumption	12KW
Folded Size	L5900*W2200*H2450	Total net weight	3.1 tons
Floor area	38m ²		
Frame structure			
序号	Name	Content	Specifications
1	Main frame (fully galvanized)	Top side beam	80*100*3.0mm square tube outsourcing 2.0 bending parts
2		Top beam	80*100*3.0mm square tube wrapped with 2.0 bending parts
3		Bottom side beam	80*100*3.0mm square tube wrapped with 2.0 bending parts
4		Bottom beam	80*100*3.0mm square tube wrapped with 2.0 bending parts
5		Hanging head	12.8 Portable Steel Anti detachment Hook
6		Steel column	80*100*3.0mm square tube outsourcing 2.0 bending parts
7	Side frame (fully galvanized)	Top frame	50*100*2.5mm square tube outsourcing 2.0 bending parts
8			40*80mm*1.8mm P-shaped pipe
9		Bottom frame	80*100*3.0mm square tube outsourcing 2.0 bending parts
10		Folding hinge	130mm galvanized hinge
11	Overall framework protective coating	Spray	Electrostatic spray molding/straight white plastic powder
12	Roof	Main external top plate	T50mm EPS color steel plate+conjugated veneer t0.4mm
13		Outer top plate of the side wing	T100mm EPS color steel plate+conjugated veneer t0.4mm
14		Internal ceiling panels	200 type ceiling panel
15	Wallboard	Side walls, front and rear	T65mm EPS color steel plate
16		Inner partition board	T50mm EPS color steel plate
17	Ground	Center floor	18mm thick fireproof cement fiber floor
18		Floor on both sides	Bambo plywood 18mm thick
19	Doors and windows	Fixed steel sliding window	920*920mm
20		Steel single door	840*2030mm
21	Electric system	Circuit breaker system	One 32A leakage protector, Voltage 220V, 50HZ
22		Light	Bull 30*30 Flat lamp, large ceiling lamp
23		Socket	Standard international three-hole five-hole sockets (socket standards can be configured according to customer requirements)
24		Light switch	Double open, single key switch (switch standard can be configured according to customer requirements)
25		Wiring	Incoming Line 6 ² , Air conditioning socket 4 ² , Ordinary socket 2.5 ² , Lighting 1.5 ² . (Circuit that meets certification requirements can be customized according to the country)
26	Accessory	Including top corner line, skirting line, corner wrapping, waterproof tape, sling, structural adhesive, and glue gun	

产品参数

PRODUCT PARAMETERS

苹果舱配置参数

1	外形尺寸/mm	长6000	5	户型	一室一卫
2		宽3300	6	入住人数	2人
3		高3000 (含底部支撑)	7	用电功率	12KW
4	占地面积	20㎡	8	总净重量	5.4 吨
外围护体系			室内精装		
序号	名称	内容	序号	名称	内容
1	钢结构	热镀锌钢框架	1	内墙	9mm欧松板 (B3级防水) + 铝塑板墙面、天花
2	外壳	铝合金外壳全方位包覆 + 氟碳烤漆全方位填充隔热保温层 (聚氨酯发泡)	2	地板	环保复合地板 (水湿压力板 + 复合地板)
3	玻璃幕墙	low-e中空隔热保温玻璃	3	卫生间	铝塑板墙面
4	窗	low-e中空隔热保温玻璃	4		卫生间门: 隐私玻璃门
5	门	断桥高级入户门 (含智能门锁)	5		高级防滑地面
6	外雨	外用氟铝灯带	6		惠达高端洗手盆、卫浴镜、抽拉式水龙头、花洒、地漏
智能、环保设备			7		欧普照明通风取暖一体浴霸
1	智能系统	智能语音控制系统	8		惠达轻智能马桶
2		插卡取电/拔卡断电控制系统	9		美的储水式热水器60L (室内)
3		背景音乐系统	10		多功能毛巾架 (可选配毛巾烘干机)
4		酒店智能门禁系统	11	排水	系统排污管道
5		室内智能电动透光窗帘	12	照明	全屋LED照明系统+室内氛围灯
6		强、弱电配电系统	13	水电	全屋水电系统 (阻燃电线/品牌漏电开关/不锈钢金属波纹管)
7		智能给排水系统	14	空调	美的1.5匹冷暖空调 (一级能效)
8		全屋智能家居	15	置物橱柜	高端生态板定制
9	可选配置	智能地暖系统	对比常规苹果舱的优势		
10		激光投影设备系统、智能新风系统	1	新型水管	不锈钢波纹管, 抗极寒, 不结垢, 一管到底永不漏水
11		高端时尚1.8米双人床 (含床垫)	2	移动插座	采用电力轨道, 插座是可拔插的, 出口时只需配套相应插座, 不需重新接线

Apple cabin configuration parameters

1	External dimensions /mm	Long 6000	5	House type	One room, one bathroom
2		Wide 3300	6	Number of people accommodated	2 people
3		High 3000 (including bottom support)	7	Power consumption	12KW
4	Floor area	20㎡	8	Total net weight	5.4 tons
Peripheral protection system			Interior decoration		
Serial Number	Name	Content	Serial Number	Name	Content
1	Steel structure	Hot dip galvanized steel frame	1	Interior wall	9mm European pine board (B3 waterproof, aluminum-plastic board wall and ceiling)
2	External shell	Aluminum alloy shell with all-round coating and fluorocarbon baking paint with all-round filling of insulation layer (polyurethane foam)	2	Floor	Environmentally friendly composite flooring (cement pressure board-composite flooring)
3	Glass curtain wall	Low-e hollow insulation glass	3	Bathroom	Aluminum plastic panel wall
4	Window	Low-e hollow insulation glass	4		Toilet door: privacy glass door
5	Door	Broken bridge advanced entrance door (including smart door lock)	5		Advanced anti slip flooring
6	Peripheral	Peripheral atmosphere light strip	6		Huida high-end washbasin, bathroom mirror, pull-out faucet, showerhead, floor drain
Intelligent and environmentally friendly equipment			7		Occupancy Lighting, Ventilation, and Heating Integrated Bathing Master
1	Intelligent system	Intelligent voice control system	8		Huida Light Intelligent Toilet
2		Card insertion and power removal control system	9		Midea storage water heater (DL indoor)
3		Background music system	10		Multi functional towel rack (optional towel dryer)
4		Hotel intelligent access control system	11	Drainage	System sewage pipeline
5		Indoor intelligent electric blackout curtains	12	Lighting	Whole house LED lighting system+indoor ambient lighting
6		Strong and weak current distribution systems	13	Hydropower	Whole house water and electricity system (flame retardant wire, brand leakage switch/stainless steel metal corrugated water pipe)
7		Intelligent water supply and drainage system	14	Air-conditioning	Midea 1.5 horsepower heating and cooling air conditioning (first level energy efficiency)
8		Whole house smart lighting	15	Storage cabinet	Customized high-end ecological board
9	Optional configuration	Intelligent electric underfloor heating system	Advantages compared to conventional Apple pods		
10		Laser projection equipment system, intelligent fresh air system	1	New type of water pipe	Stainless steel corrugated water pipe, resistant to extreme cold, without scaling, one pipe will never leak water after all
11		High end fashionable 1.8m double bed (including mattress)	2	Mobile socket	Adopting power rail, the socket can be plugged and unplugged. When exiting, only the corresponding socket needs to be matched without the need for rewiring