

# Mounting a BalanceBox® 400 to a brick wall

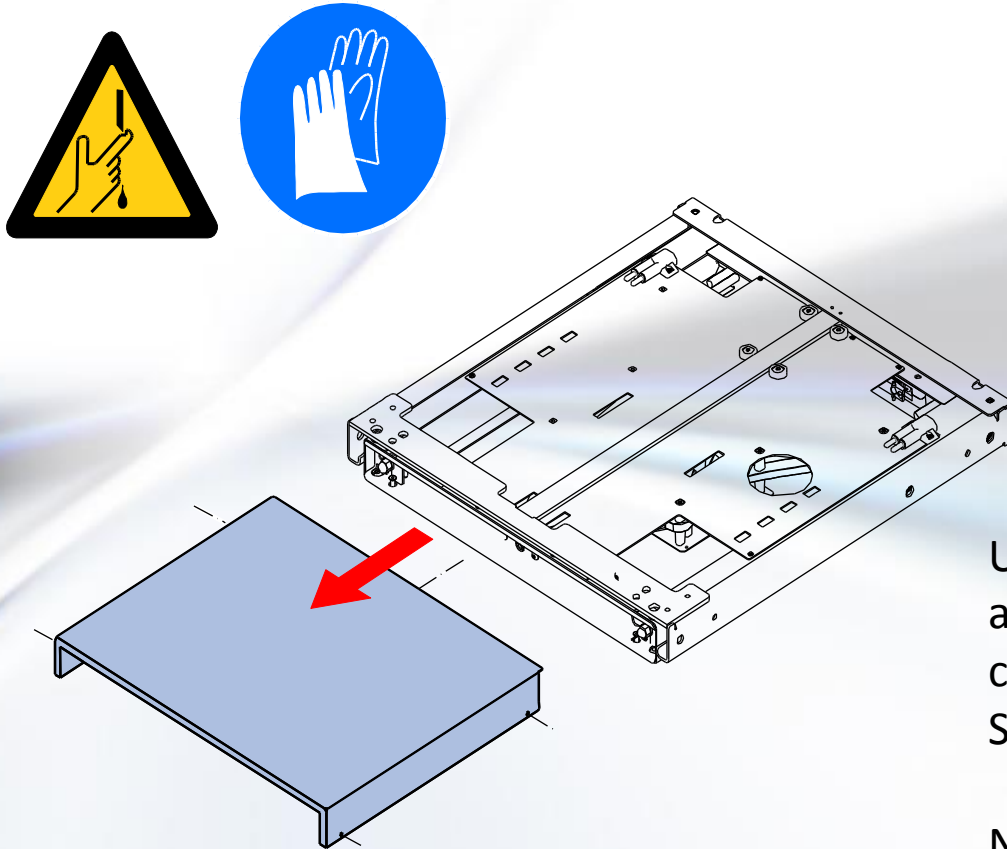

Unpack the BalanceBox® 400 and remove the Wall frame cover and its bag of screws. Slide the cover out at the top.

NOTE: the cover is NOT included with the BalanceBox® 400H

# Mounting a BalanceBox® 400 to a brick wall

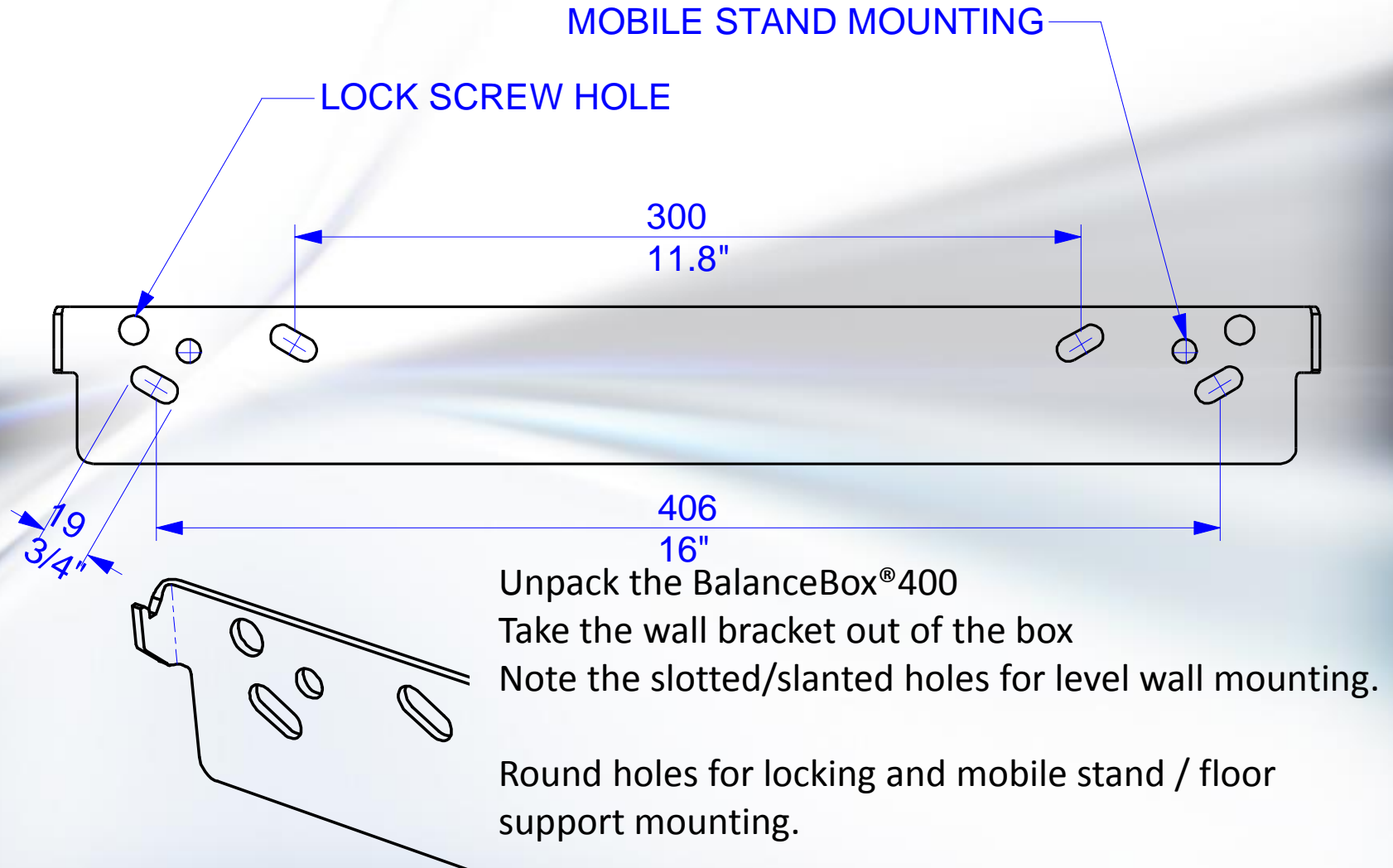

# Mounting a BalanceBox<sup>®</sup> 400 to a brick wall

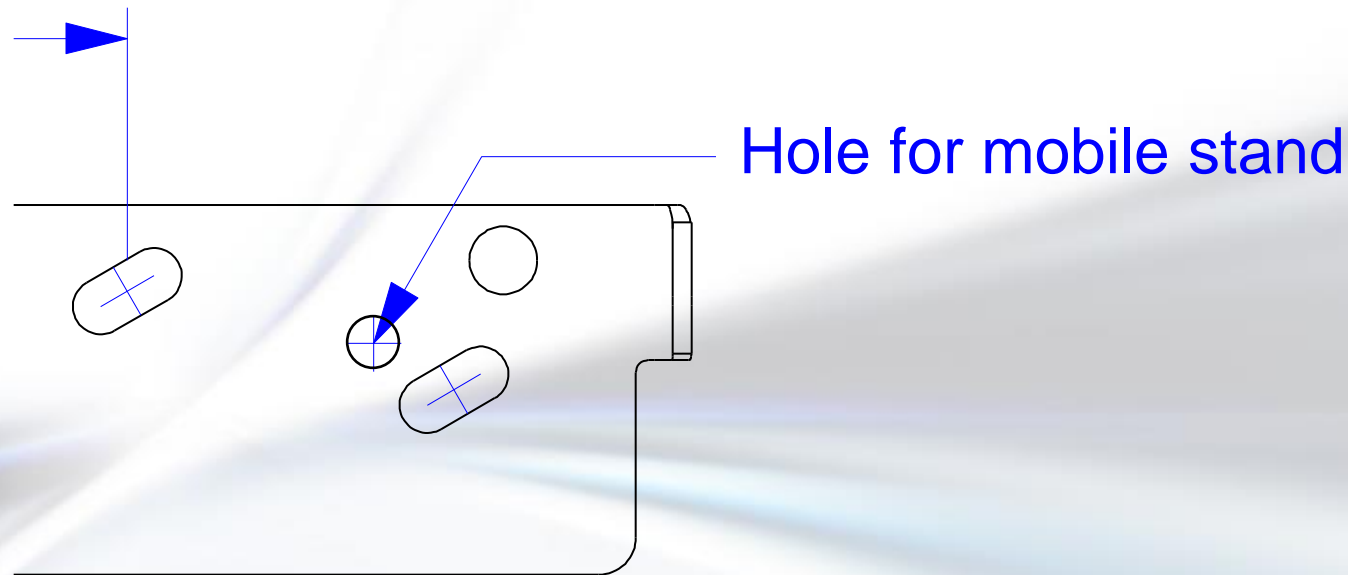

Use the indicated hole for mounting on the Mobile stand

# Mounting a BalanceBox<sup>®</sup> 400 to a brick wall

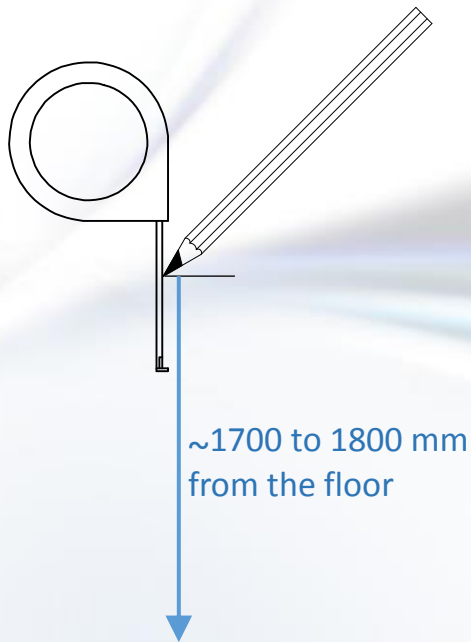

Measure the mounting height  
from the floor.

And mark it



# Mounting a BalanceBox® 400 to a brick wall

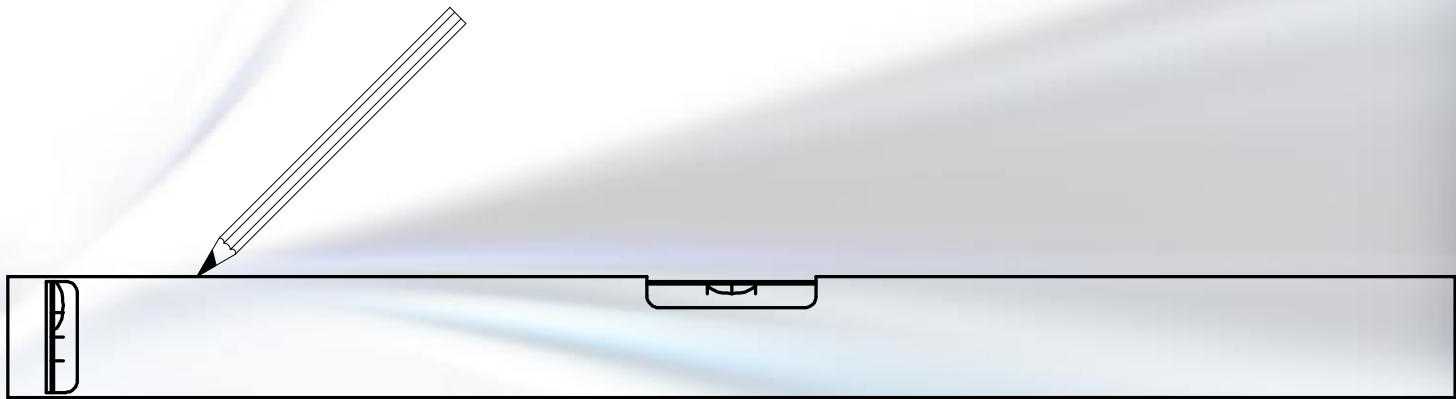

Using a level, mark the horizontal position of the other hole level to the first hole.  
(distance 406mm / 16")

# Mounting a BalanceBox<sup>®</sup> 400 to a brick wall

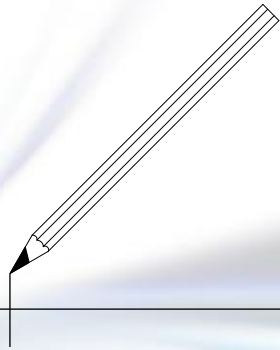

Mark the position of both holes  
at a distance of 406mm /16"

# Mounting a BalanceBox<sup>®</sup> 400 to a brick wall

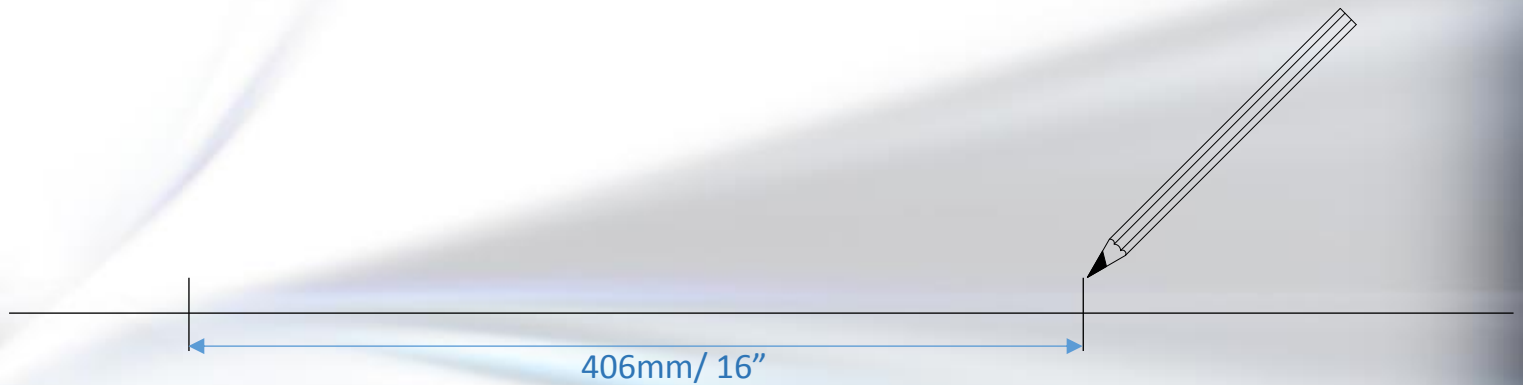

Mark the position of both holes  
at a distance of 406mm / 16"

# Mounting a BalanceBox<sup>®</sup> 400 to a brick wall

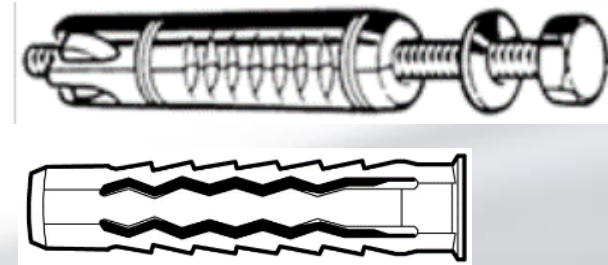
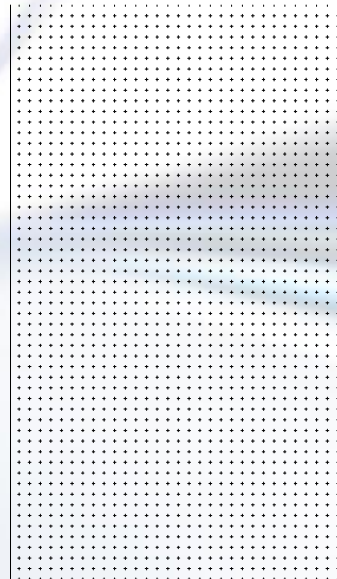

Drill the holes in the brick wall, use a 10 mm drill for plastic plugs and 8mm diameter screws, or appropriate drill for other type wall anchors.



# Mounting a BalanceBox<sup>®</sup> 400 to a brick wall

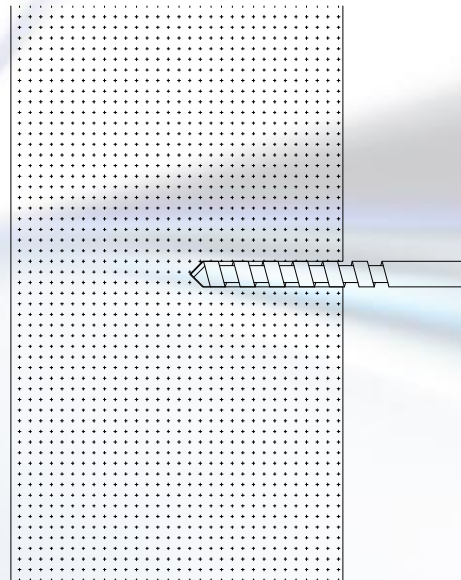
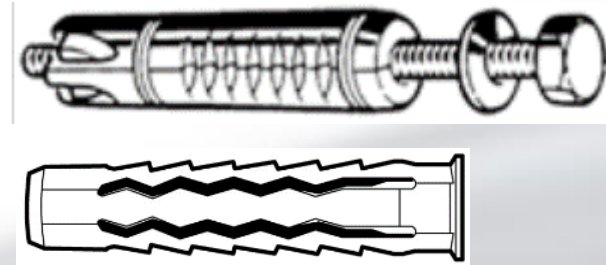

Drill the holes in the brick wall, use a 10 mm drill for plastic plugs and 8mm diameter screws, or appropriate drill for other type wall anchors.

# Mounting a BalanceBox® 400 to a brick wall

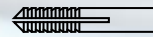
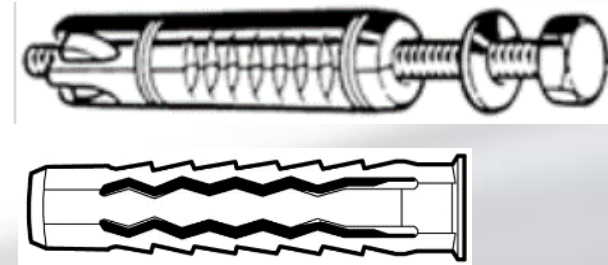
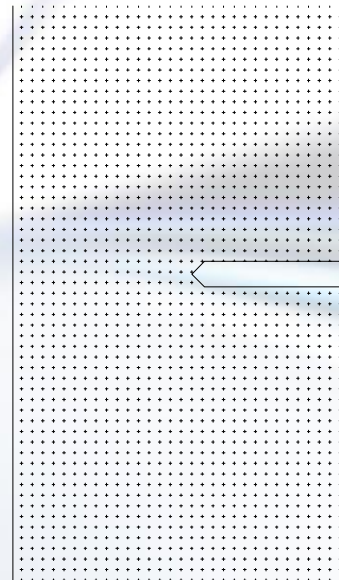

Insert the plug or wall anchor.  
Mounting hardware used  
depends on the type of wall.

Hardware is **not** included.

# Mounting a BalanceBox® 400 to a brick wall

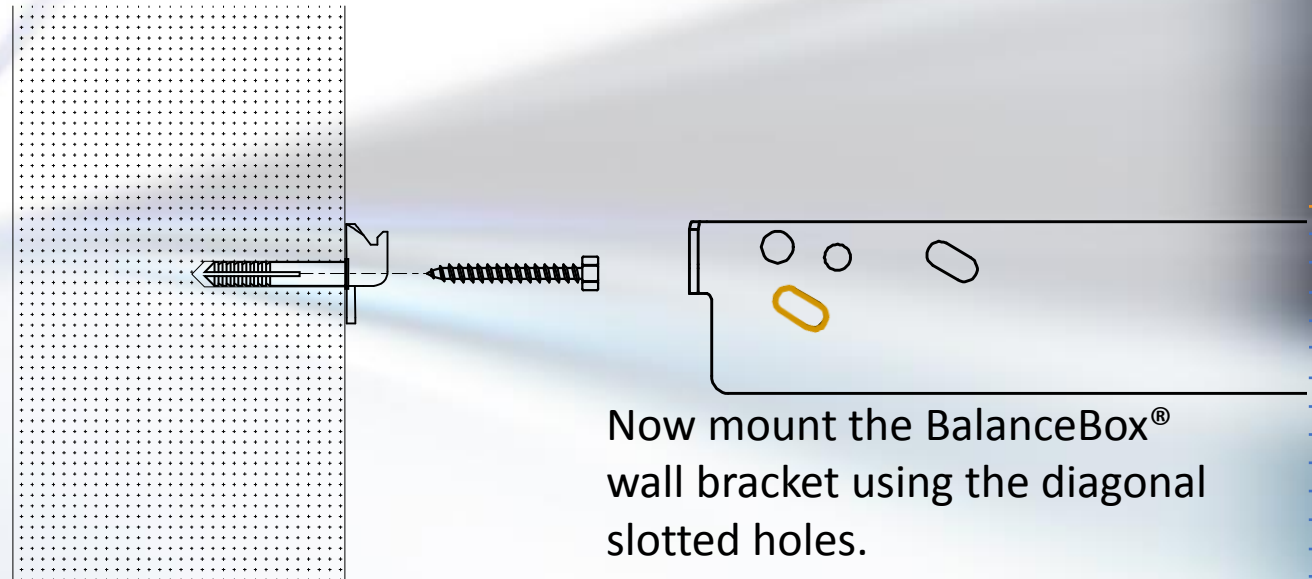

Do not tighten fully

# Mounting a BalanceBox® 400 to a brick wall

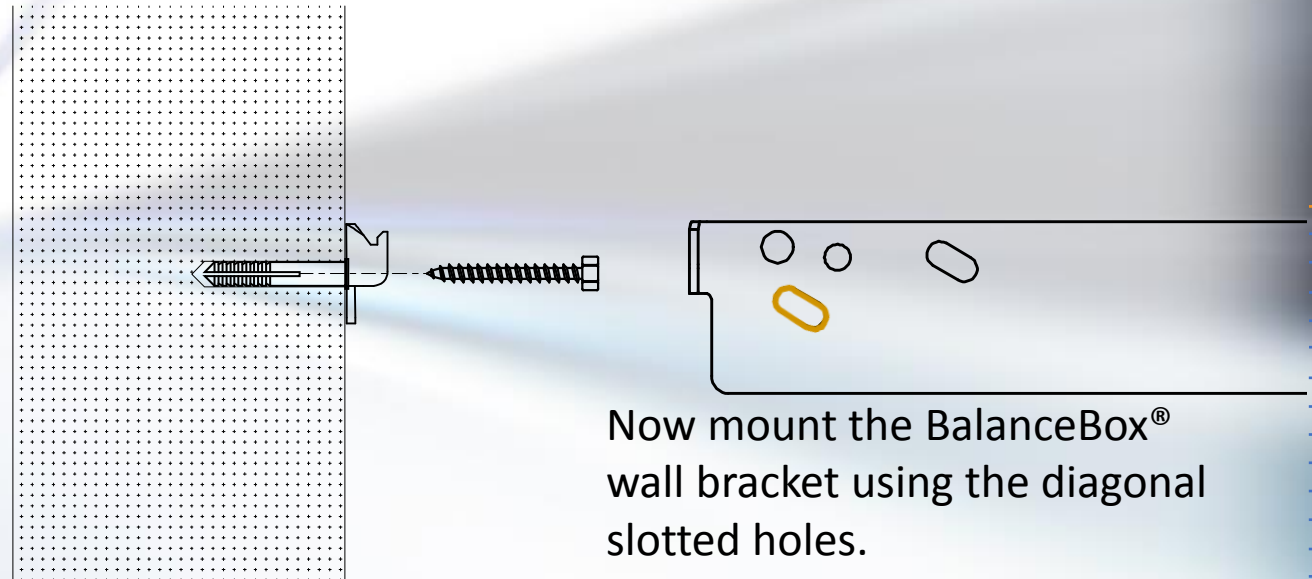

Do not tighten fully

# Mounting a BalanceBox® 400 to a brick wall

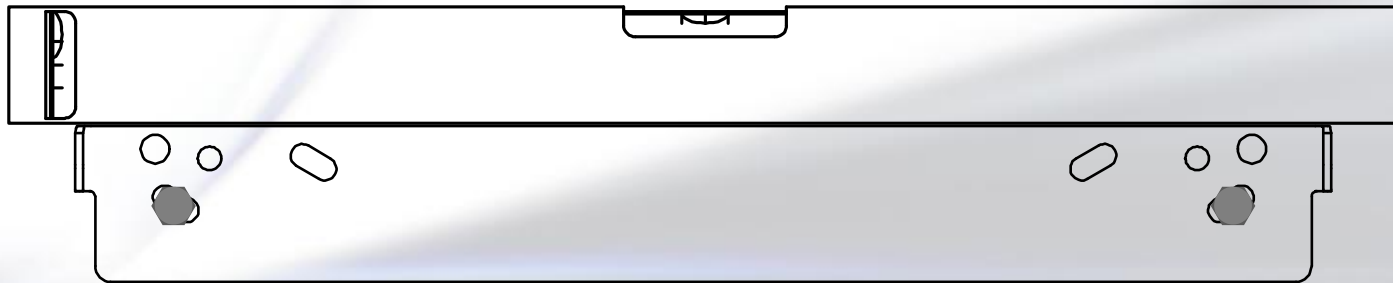

Level the wall bracket

And tighten both screws

# Mounting a BalanceBox<sup>®</sup> 400 to a brick wall

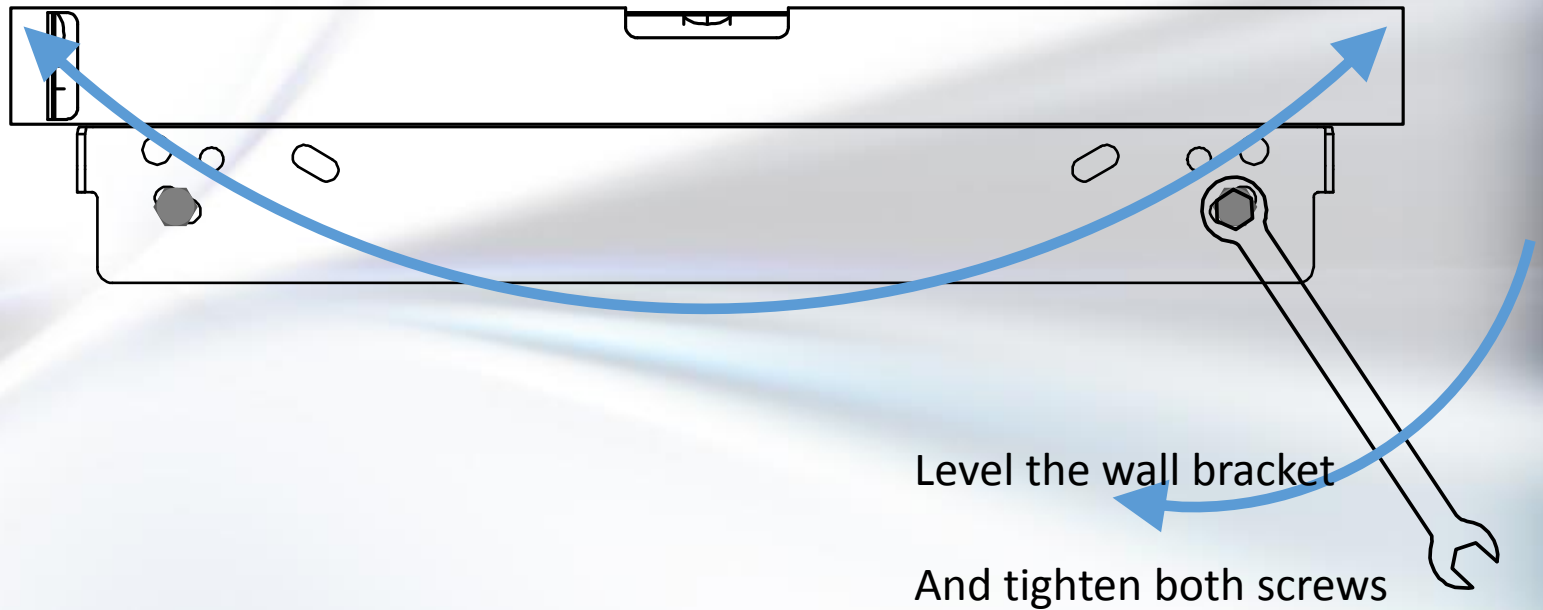

# Mounting a BalanceBox® 400 to a brick wall

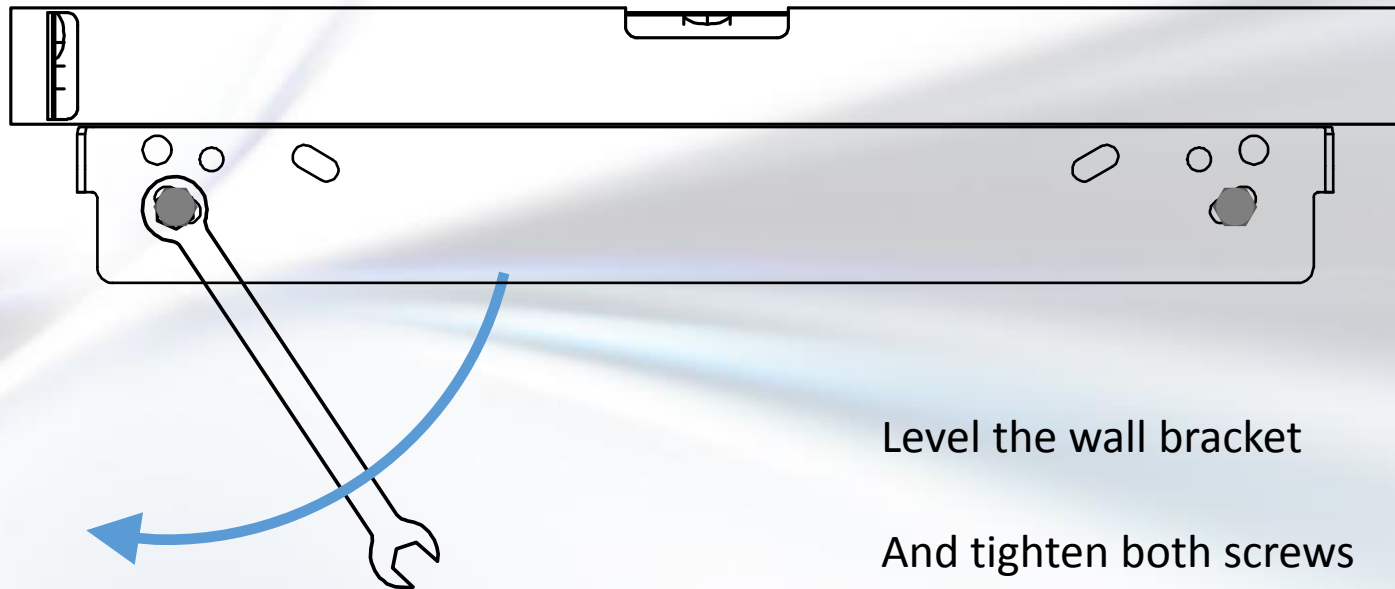

Level the wall bracket

And tighten both screws

# Mounting a BalanceBox® 400 to a brick wall

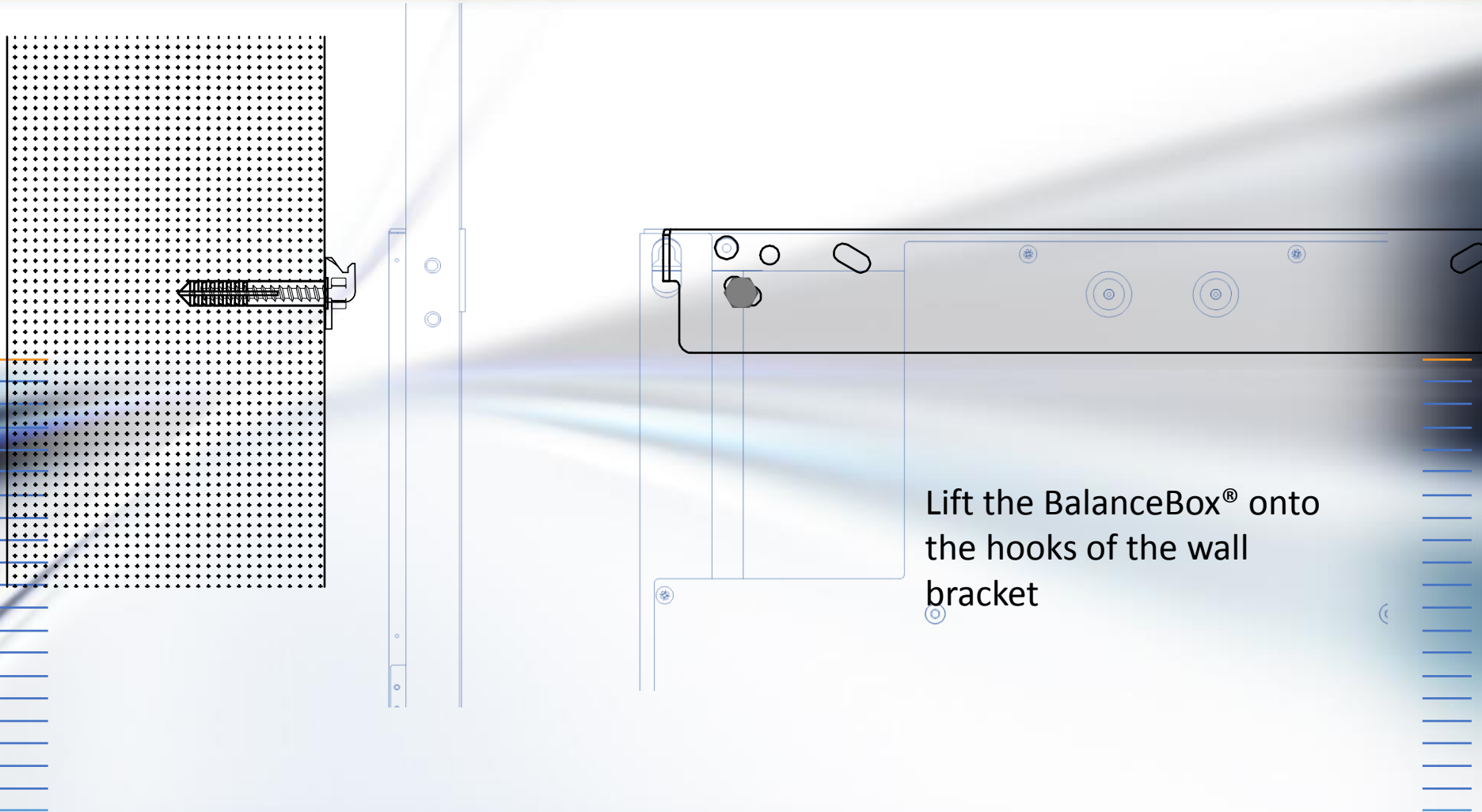



# Mounting a BalanceBox® 400 to a brick wall

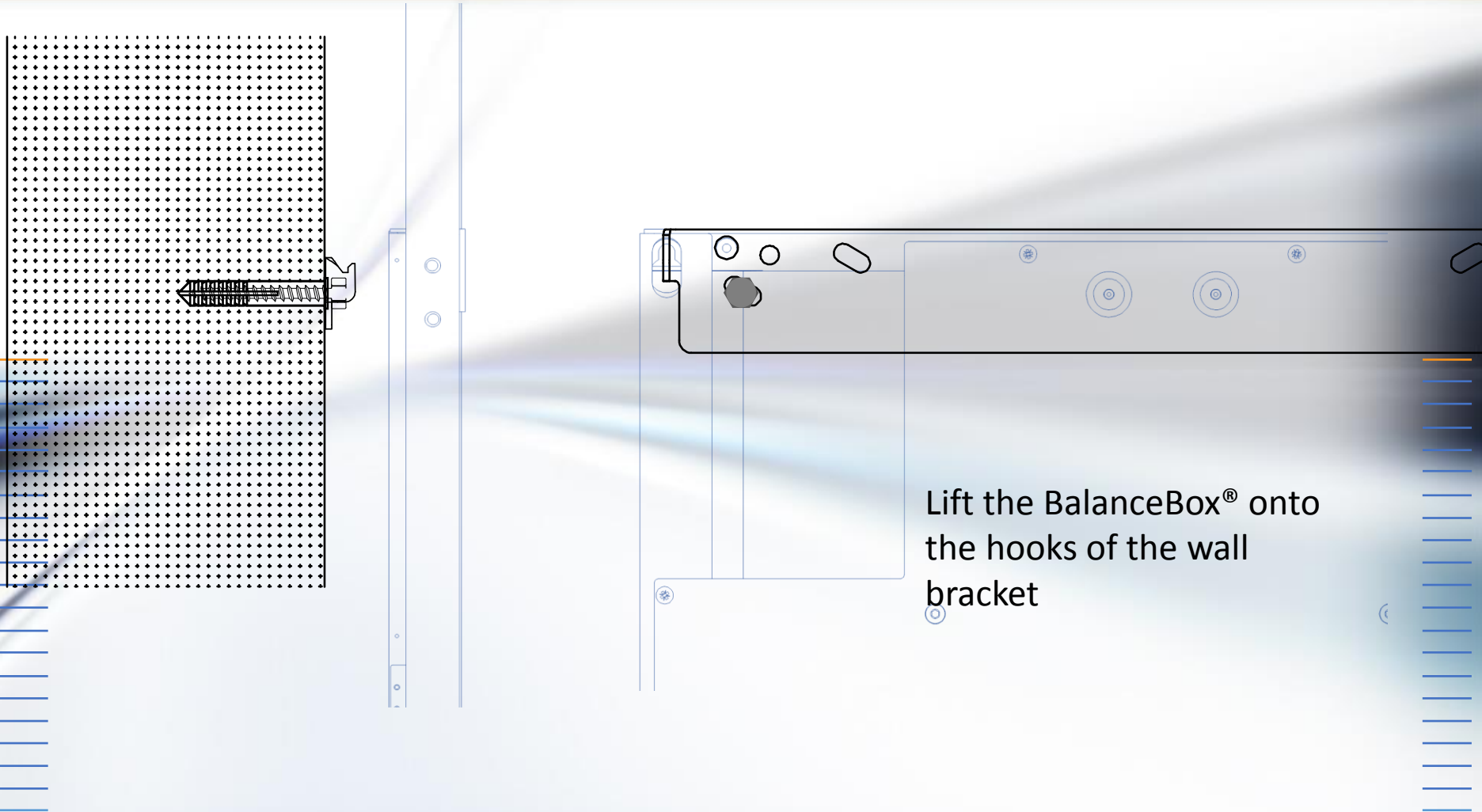

# Mounting a BalanceBox® 400 to a brick wall

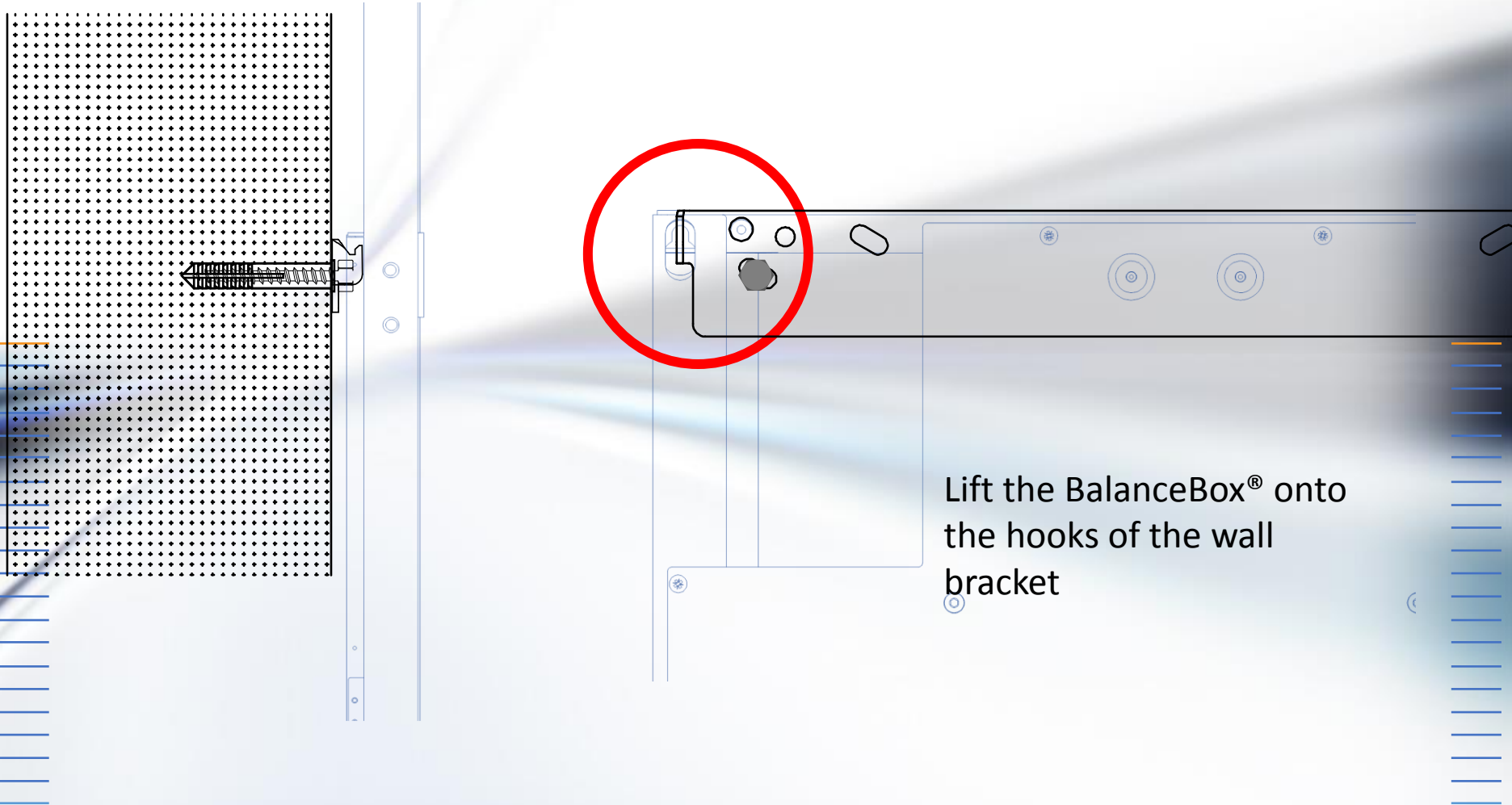

# Mounting a BalanceBox® 400 to a brick wall

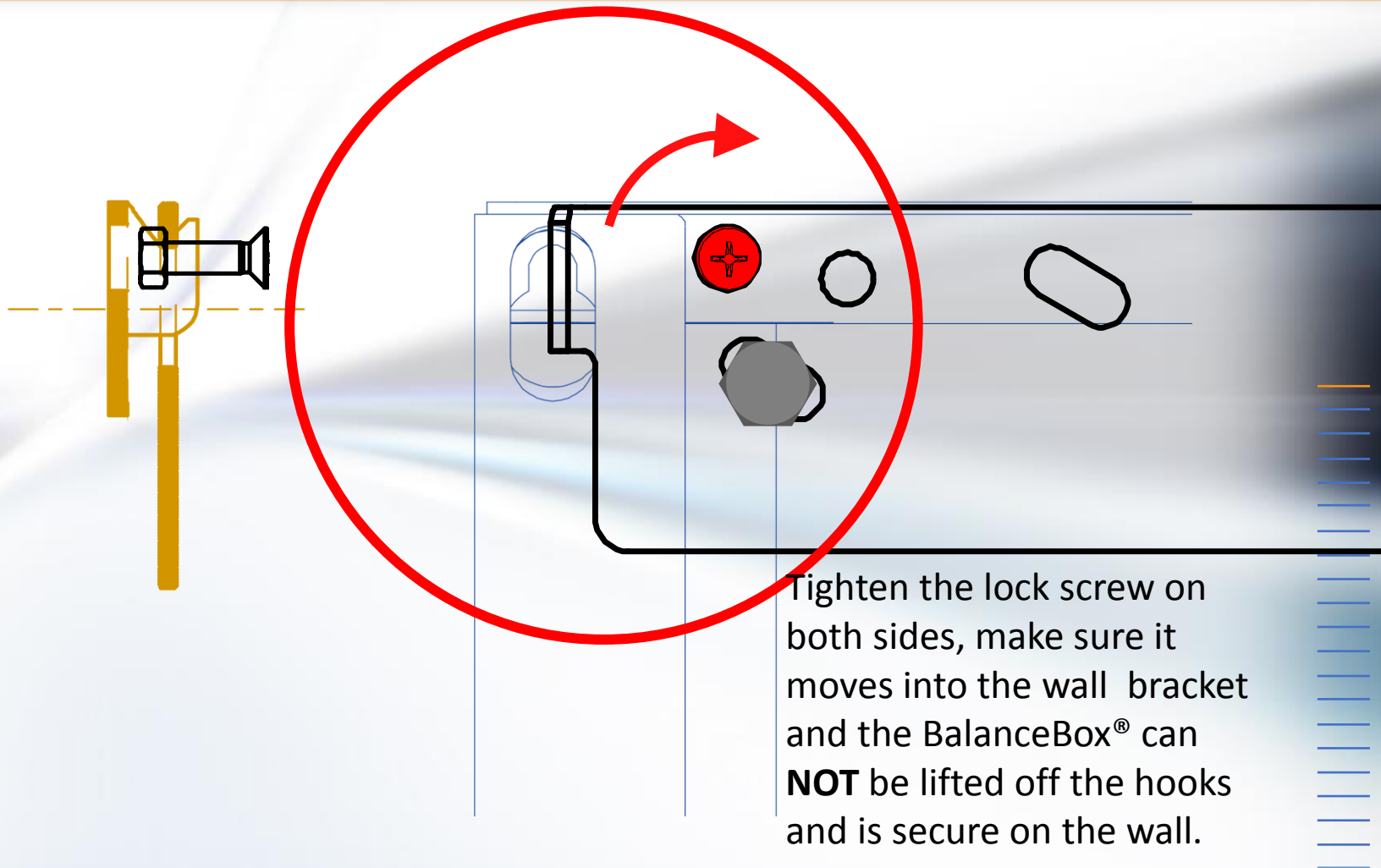

# Mounting a BalanceBox® 400 to a brick wall

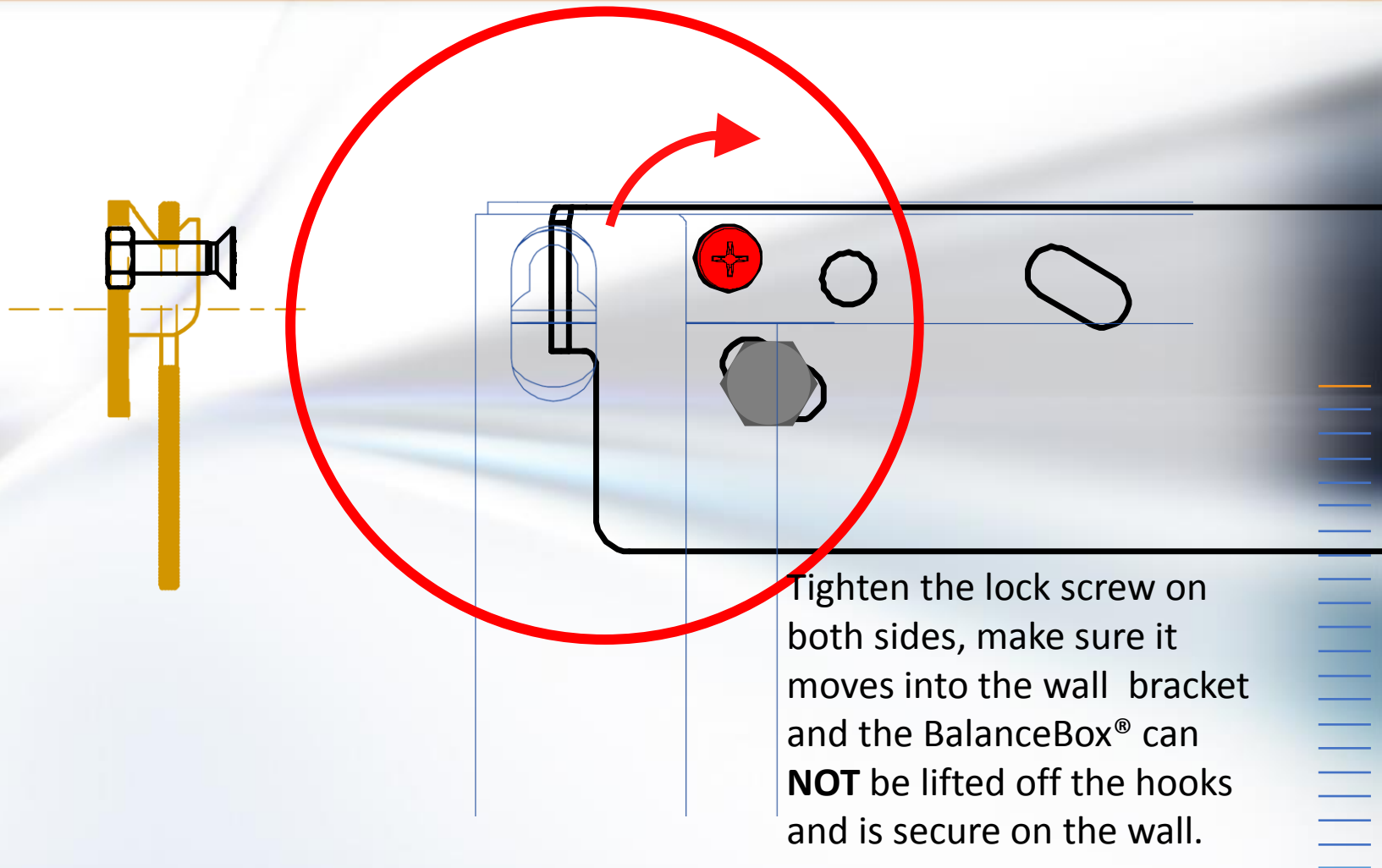

# Mounting a BalanceBox® 400 to a brick wall

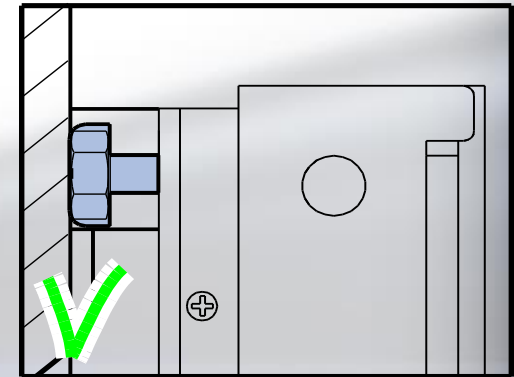
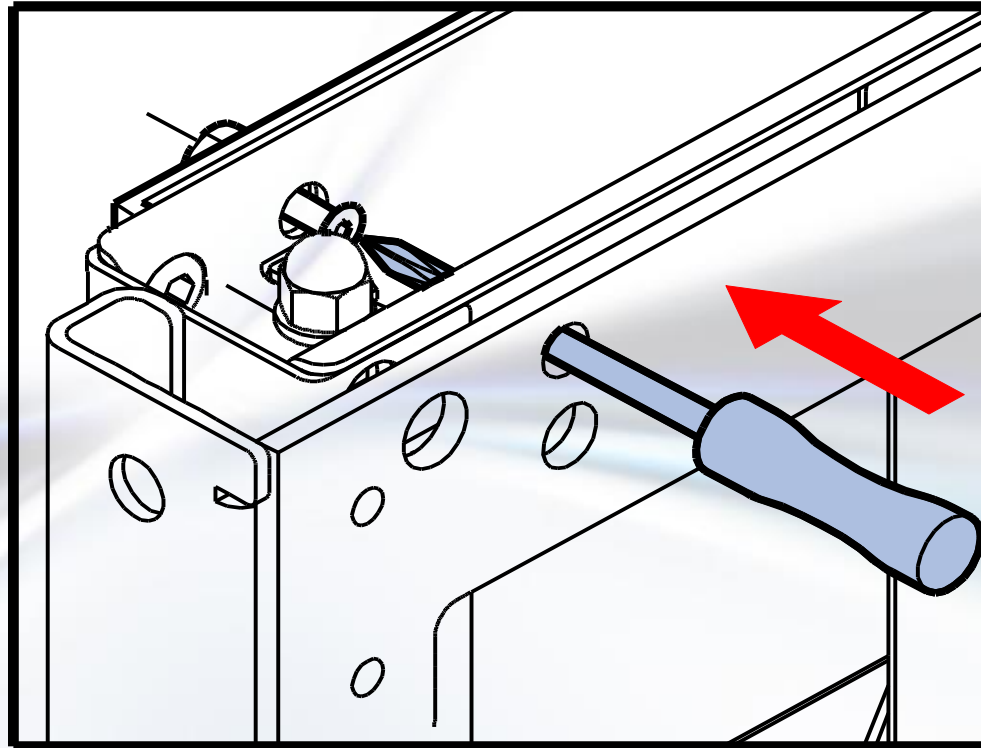

Tighten the lock screw on both sides, make sure it moves into the wall bracket and the BalanceBox® can **NOT** be lifted off the hooks and is secure on the wall.

# Mounting a BalanceBox<sup>®</sup> 400 to a brick wall



Always align the BalanceBox vertically!

Avoid it crashing into the wall during use and noise from misalignment.

# Mounting a BalanceBox<sup>®</sup> 400 to a brick wall

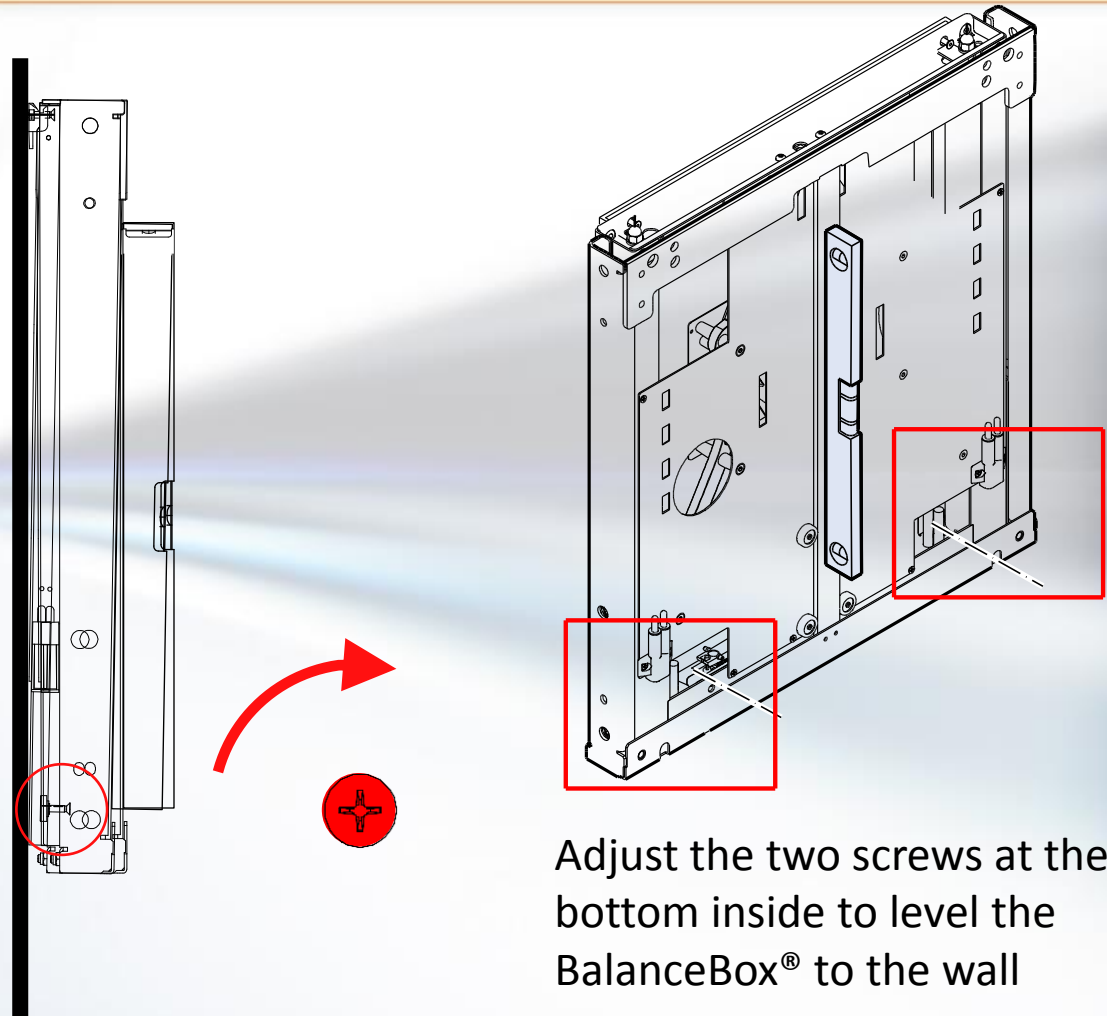





# Mounting a BalanceBox® 400 to the Mobile stand

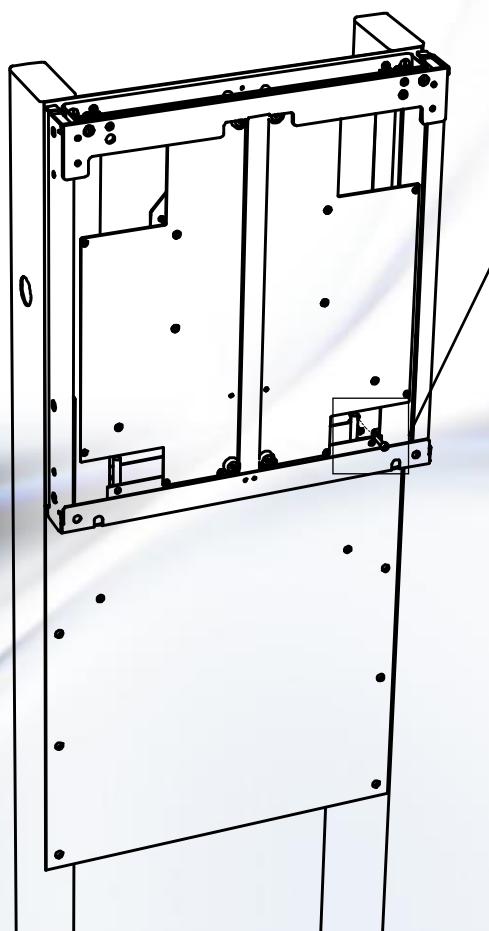

Mobile stand

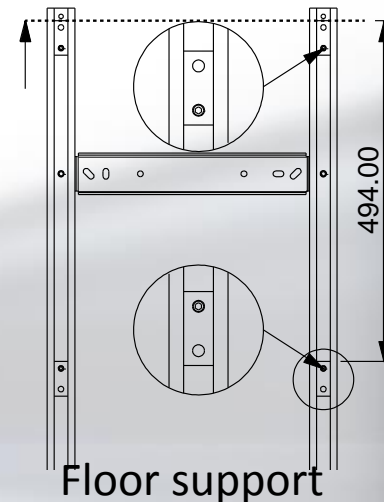
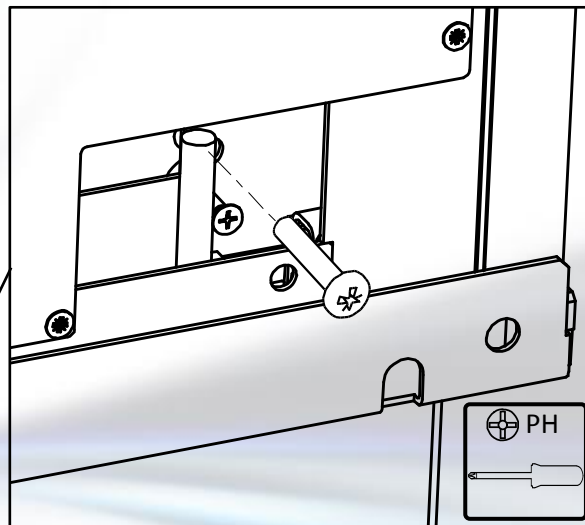

Floor support

## NOTE:

When mounting the BalanceBox® to the Mobile stand or floor support, or when using the Tilt feature always use the bottom mounting positions in addition to the wall bracket!



# Mounting a BalanceBox<sup>®</sup> 400 to a brick wall

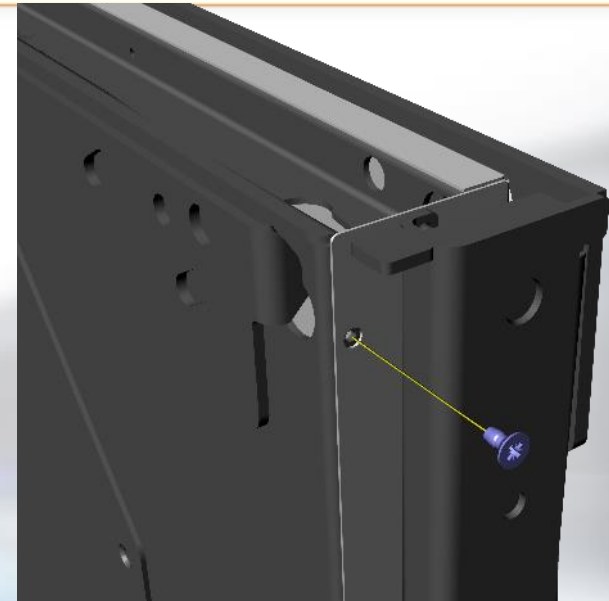
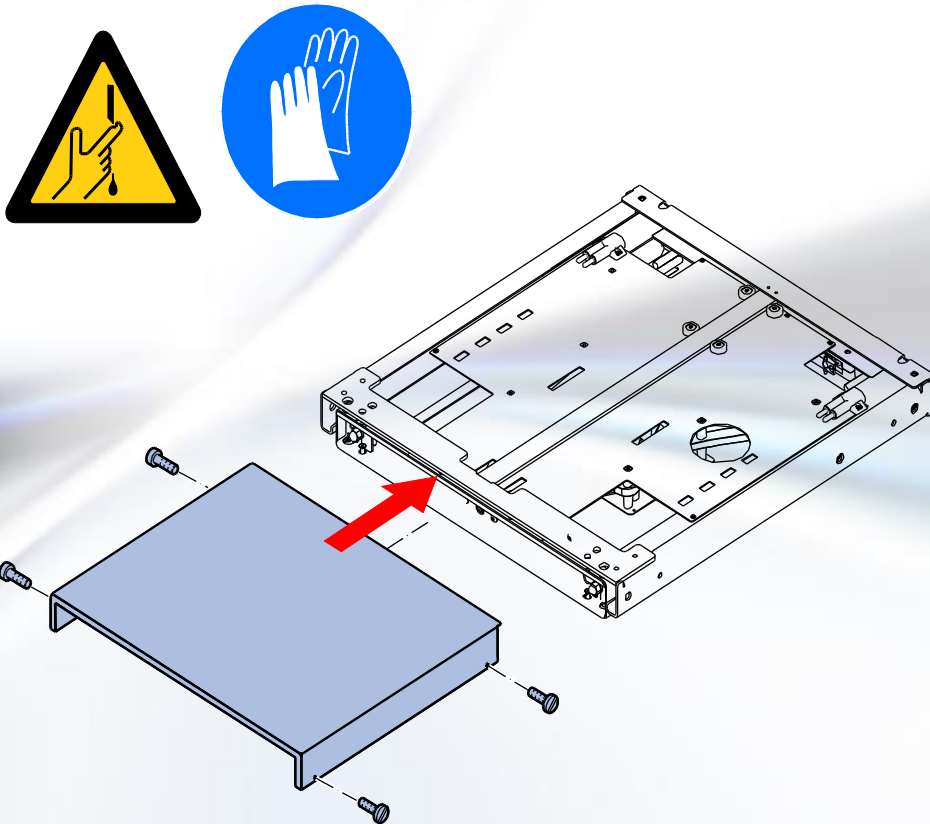

Mount the wall frame cover by sliding it in at the top between the wall frame and the application frame.  
Tighten the screws

NOTE: the cover is NOT included with the BalanceBox<sup>®</sup> 400H



# Mounting the Vesa bracket to the BalanceBox<sup>®</sup> 400

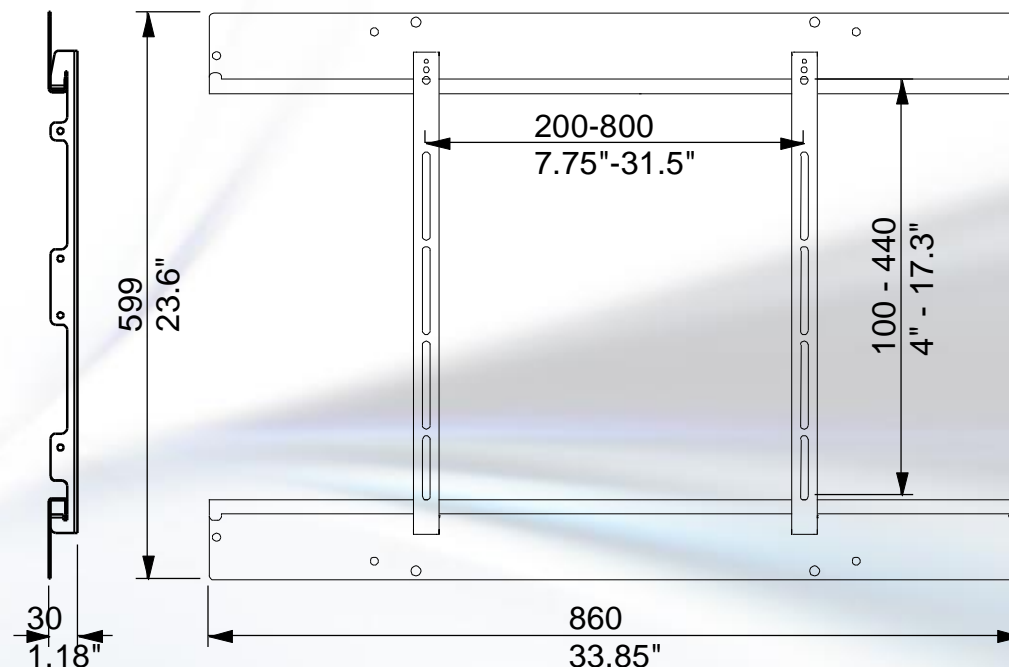

Vesa bracket is specific for mounting flatscreens to the BalanceBox<sup>®</sup>

- Metric hardware 4, 6 and 8 mm is included
- Various holes for anti theft steel cable provided



# Mounting the Vesa bracket to the BalanceBox® 400

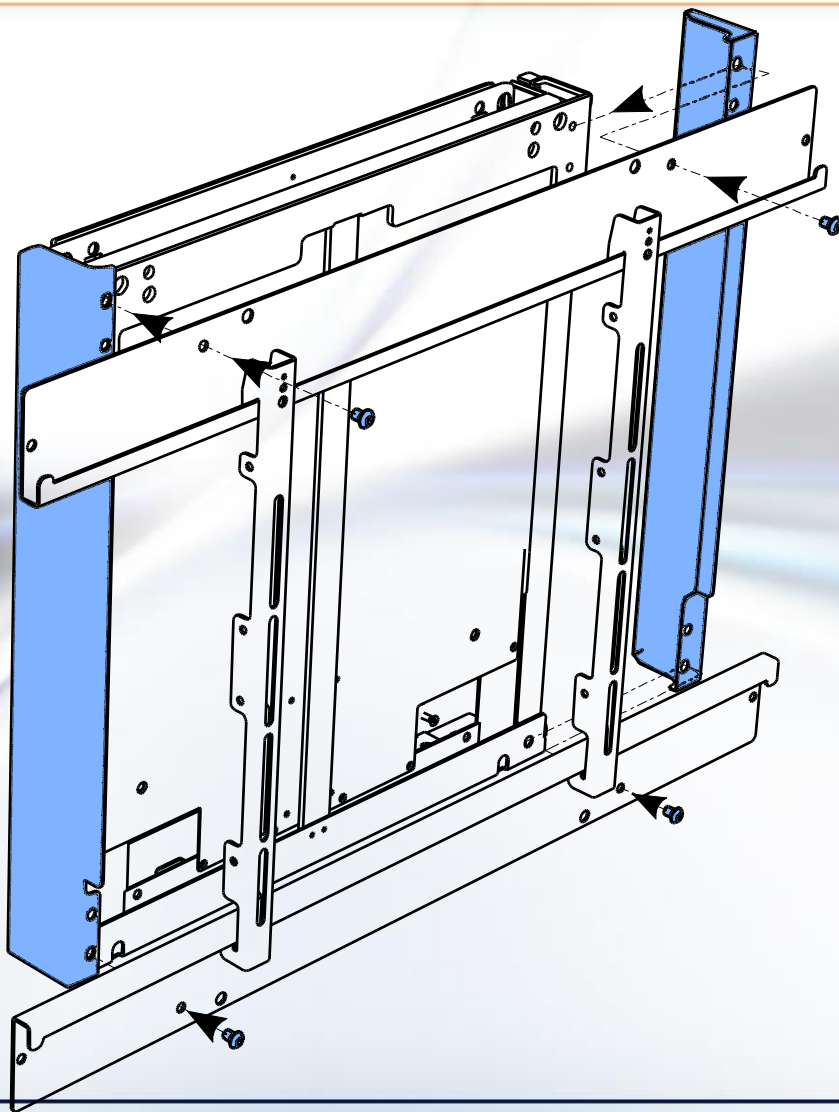

Mount both horizontal plates to the BalanceBox® together with the BalanceBox® side covers.

Use 8 mm (12mm/½" length max!) hex. buttons and a 5mm allen key



M8 screws longer than 12mm/ ½" will cause BalanceBox® to block.

NOTE: Top and bottom are identical but mounted mirrored



# Mounting the Vesa bracket to the BalanceBox<sup>®</sup> 400

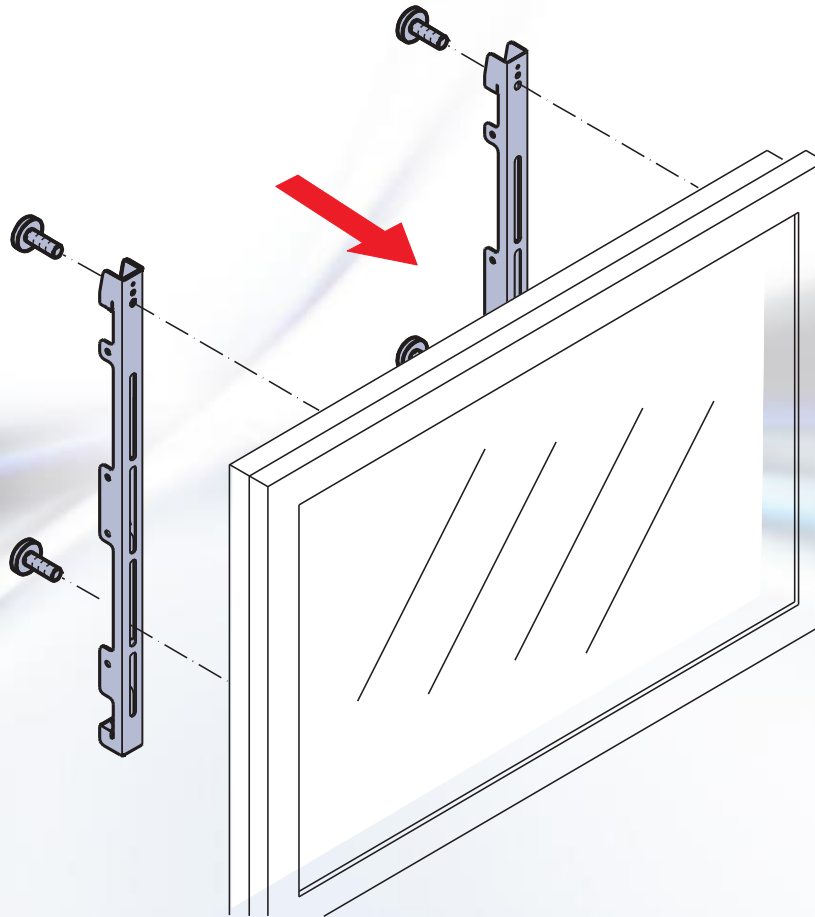

Mount both vertical profiles to the Flatscreen vesa connection

Use the metric 4, 6 or 8 mm screws provided (length 12mm/ ½") or fasteners /length as specified by screen manufacturer.

NOTE: round holes are the top of the profiles

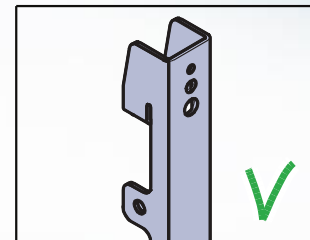
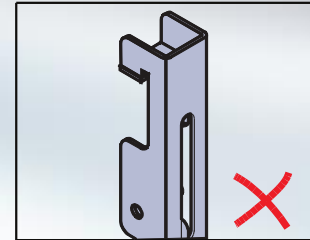



# Mounting the Vesa bracket to the BalanceBox® 400

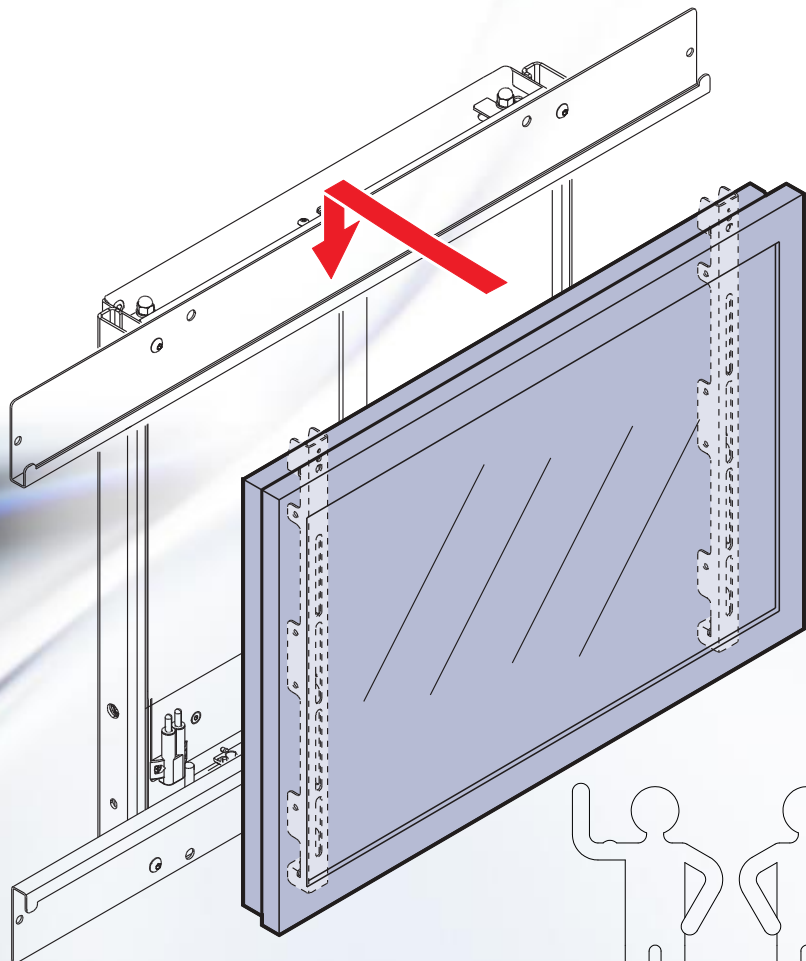

Lift the screen, with the vertical profiles mounted, on to the horizontal plates mounted earlier on the BalanceBox®

Make sure hooks on the top should be engaged fully on both sides.

A two-man job!

NOTE: shift the screen left/right to center it on the BalanceBox®

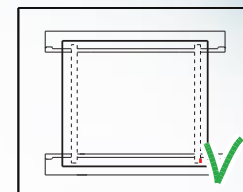
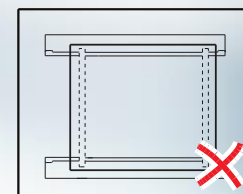
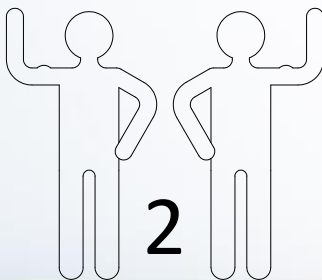



# Mounting the Vesa bracket to the BalanceBox® 400

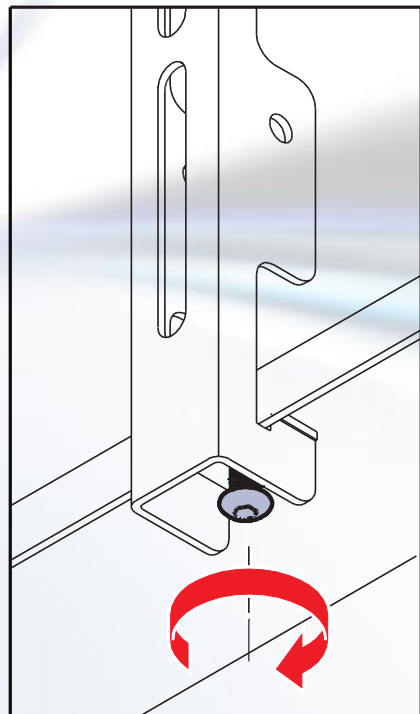
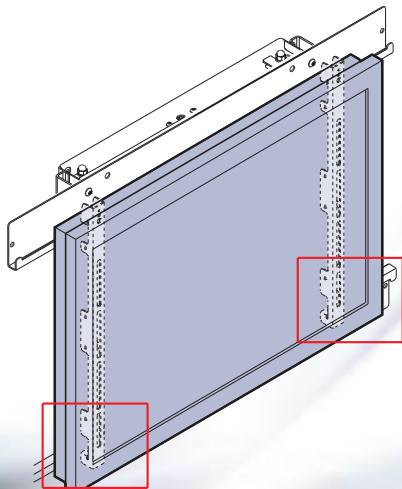

Tighten the 6 mm buttonhead screws from the bottom to secure the screen on the BalanceBox®

Use a 4 mm alan key, preferably a screwdriver style tool as shown.





# Setting the springs on a BalanceBox<sup>®</sup> 400

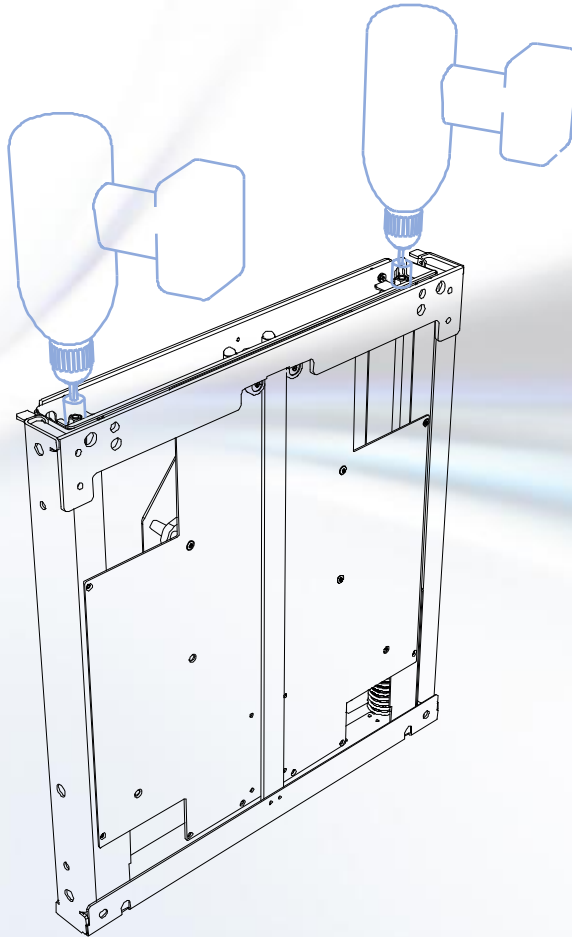
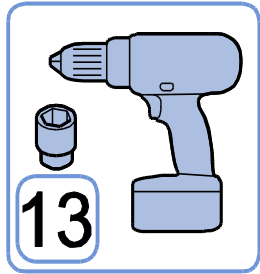

Balancing:  
Springs are always fully  
tightened for safety.

Use a drill driver and 13 mm  
socket, rotate counter clockwise  
(loosen)

Do 3 seconds left and 3 seconds  
right until the application starts  
to lower.

Now tighten until balanced