



# PRODUCTS



<http://www.mekonneedle.com>

MEDICAL NEEDLE EXPERT



**SHANGHAI MEKON MEDICAL DEVICES CO., LTD.**

Tel: 0086-13916581865  
Tel: 0086-21-39557985  
Fax: 0086-21-39555265  
e-mail: [info@mekonneedle.com](mailto:info@mekonneedle.com)  
skype: jack.qu1  
Add.: 526 No. 697-3 lingshi road shanghai 200072 China  
[www.mekonneedle.com](http://www.mekonneedle.com)  
[mekonneedle.en.alibaba.com](http://mekonneedle.en.alibaba.com)

**SHANGHAI MEKON MEDICAL DEVICES CO., LTD.**

# Company profile

Shanghai Mekan founded in 1996, as the leading medical device company, we are committed to the needle products development and production. ISO 9001 quality system, CE certification, we will provide secure and efficient products to market.

Mekan products and services include:

Needles:

Insulin pen needle, blood collection needle, lancet, dental needle, disposable needle, spinal needle, epidural needle, scalp vein set, acupuncture needle, make up needle/beauty needle, tattoo needle, air needle, chiba needle, huber needle, fistula needle,

biopsy needle, different irrigation needle, introducer needle, bone marrow biopsy needle, I.V catheter, veterinary needles and develop special needles according to customer's drawing/ requirements.

Infusion and injection products:

Infusion set, syringes, new product design and mold making.

Mekan mission:

Mekan committed to public health needs, by listening to customer needs and service, we can better understand customer needs, and this helps to improve our existing products and develop new products.

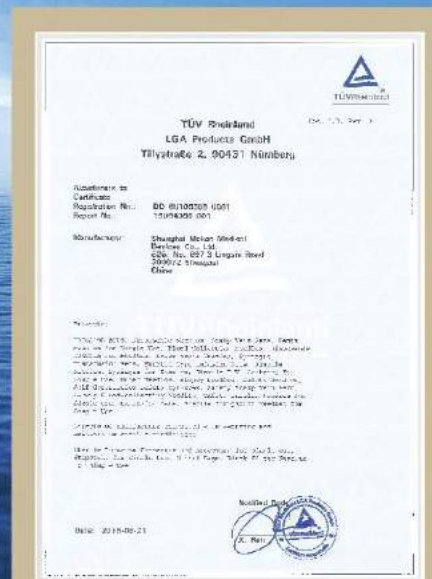



<http://www.mekonneedle.com>

SHANGHAI MEKON MEDICAL DEVICES CO., LTD.

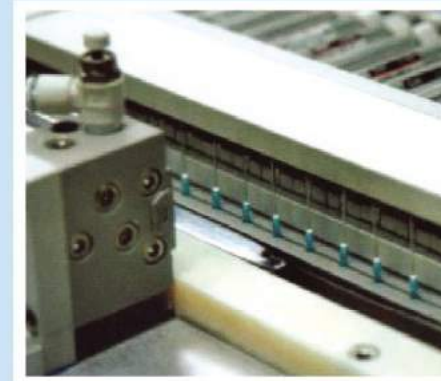



# Catalogue

Special Needles.....	1-2
Disposable Needles.....	3-4
Safety Disposable Needles.....	5-6
Scalp Vein Sets/Safety Scalp Vein Sets.....	7-8
Blood Collection ( Multi-Sample) Needles.....	9-10
Safety Blood Collection Set.....	11-12
Safety Blood Collection Needle.....	13-14
Blood collection assembly Product.....	15-16
Spinal Needles.....	17-18
Epidural Needles.....	19
Introducer Needles.....	20
I.V Catheter.....	21-22
A.V Fistula Needles.....	23-24
Insulin Pen Needles.....	25
Safety Pen Needle.....	26
Huber Needles.....	27-28
Micro Cannula for Fillers.....	29
Mesotherapy needle.....	30
Hair transplant needle.....	31
Low Dead Space Needle.....	32
Veress Needle.....	33
Biopsy Needle.....	34
Chiba Needles.....	35
Bone Marrow Biopsy Needles.....	36
Blunt Fill Needle&Blunt Filter Needle.....	37
Irrigation needle.....	38
Dental irrigation needle.....	39
Dental Needles.....	40
Cannulas.....	41-42
Special Plastic Needle.....	43
Polycarbonate Syringe.....	44
Syringe/Safety Syringe.....	45
Insulin Syringe.....	46
Enteral Syringe.....	47
Oral Syringe.....	48
NR-fit Syringe.....	49
NR-fit Anaesthesia Needles.....	50
NR-fit Stopcocks.....	51
NR-fit Extension Sets.....	52



<http://www.mekonneedle.com>

## Special Needles

- ◆ Made of high quality stainless steel 304 or 316
- ◆ Producing all kinds of special needles required by our customers

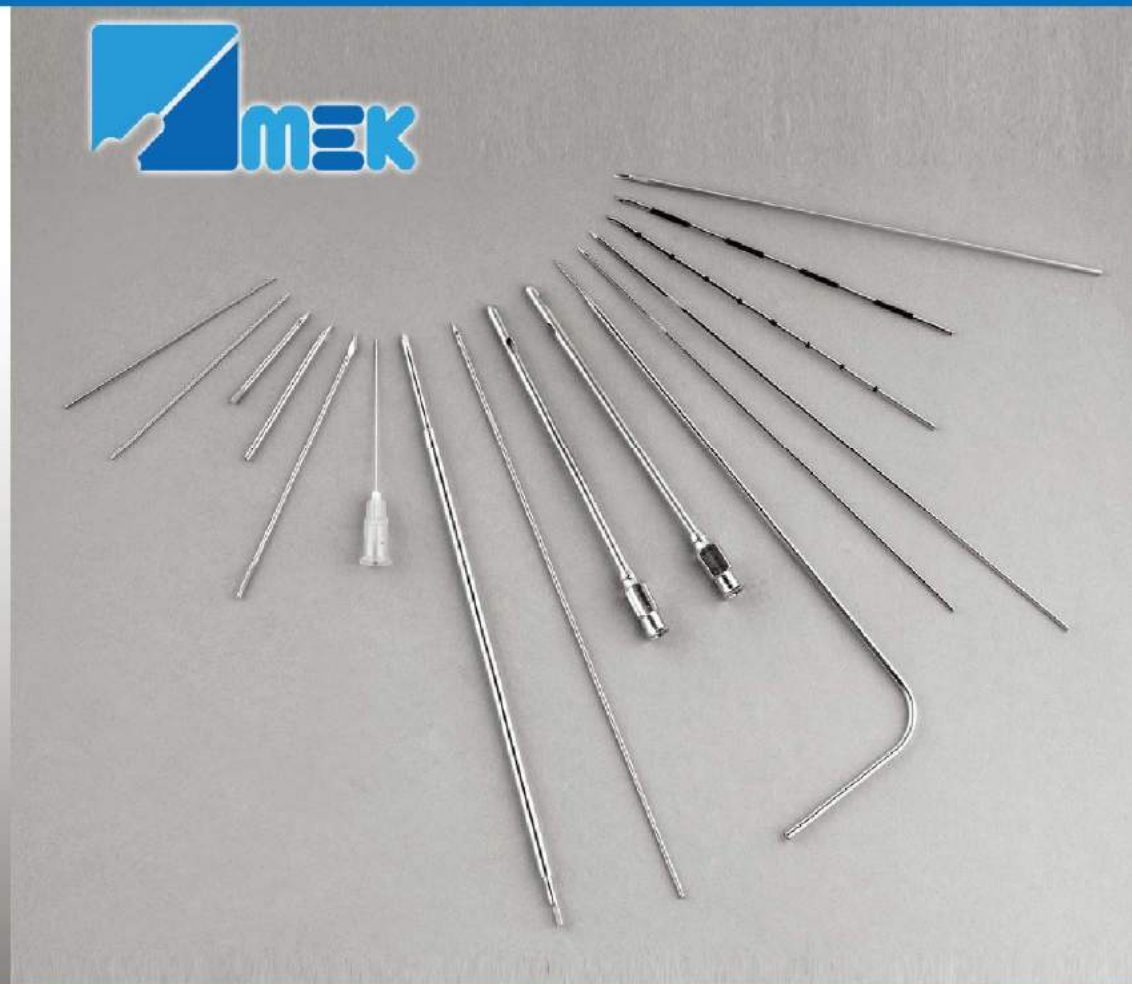
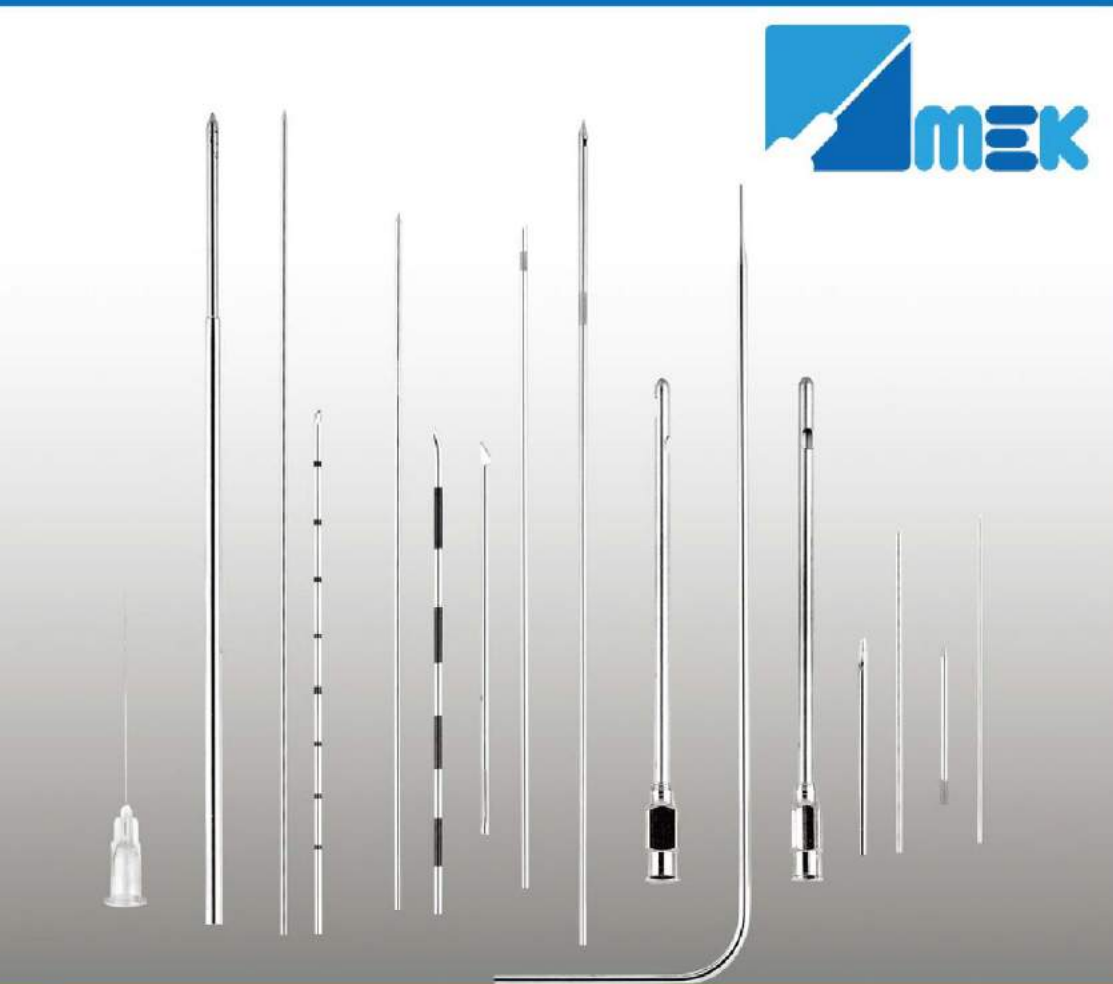

## Disposable Needles

- ◆ Made of high quality stainless steel
- ◆ With large ID and high flow
- ◆ Semi-transparent needle-hub for the convenient observation of blood reflux
- ◆ Delicately-designed needle-point with features of sharpness, smooth puncture, less damage to the tissue, less painful feeling to the patient
- ◆ Size distinguished by the needle-hub's color for the clear recognition
- ◆ The flexible supply form: in bulk or pack, sterilized or unsterilized
- ◆ Production of all kinds of special needles required by our customers
- ◆ Packing types: in bulk or in blister

### Color codes and specifications for hypodermic needle

SIZE OD (mm)	GAUGE	COLOR & CODE	LENGTH										ID		BEVEL ANGLE		REF		
			4 1/8"	6 1/4"	8 1/3"	13 1/2"	16 5/8"	20 3/4"	25 1"	32 1 1/4"	38 1 1/2"	50 2"	RW	TW	Long bevel	Short bevel			
0.25	31G	blue																	01-000
0.30	30G	lightyellow																	01-001
0.33	29G	red																	01-002
0.36	28G	blue-green																	01-003
0.40	27G	grey																	01-004
0.45	26G	brown																	01-005
0.50	25G	orange																	01-006
0.55	24G	purple																	01-007
0.60	23G	blue																	01-008
0.70	22G	black																	01-009
0.80	21G	green																	01-010
0.90	20G	yellow																	01-012
1.10	19G	cream																	01-013
1.20	18G	pink																	01-014
1.60	16G	white																	01-015
1.80	15G	blue-grey																	01-016
2.10	14G	pale green																	01-017

Remark: normal size in above table, we can also make special size as clients' request.



## ◆◆ Safety Disposable Needles

### ◆ Product Use:

It can match with normal syringe in clinical injection of liquid medicine, which can effectively prevent the acupuncture accident.

### Product Features:

1. It can match with all kinds of syringes with standard luer tip.
2. After injection, only need to push upward lightly or knock the safety protector, which can immediately achieve the purpose of protecting the needle tip.
3. Multiple protections, the safety protector will not be off accidentally.
4. Effective function and simple design can reduce the cost of safety injection.



### Using step:



Assemble the safety needle on the luer tip of sterilized syringe.

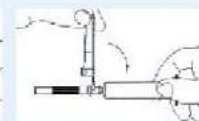

Open the safety protector, which will open automatically under the elastic force.

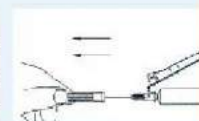

Take off the protector pull the plunger lightly to absorb the medicine liquid.



After injection, apply upward force on the safety protector, which will return automatically under the elastic force.



Apply force continually until the safety protector covers the needle.



Medical waste storage.

### ◆◆ Color codes and specifications for safety needle

SIZE		COLOR	LENGTH						ID		BEVEL ANGLE		REF
OD (mm)	GAUGE	COLOR & CODE	13	16	20	25	32	38	RW	TW	Long bevel	Short bevel	
			1/2"	5/8"	3/4"	1"	1 1/4"	1 1/2"					
0.45	26G	brown											SN-001
0.50	25G	orange											SN-002
0.55	24G	purple											SN-003
0.60	23G	blue											SN-004
0.70	22G	black											SN-005
0.80	21G	green											SN-006
0.90	20G	yellow											SN-007
1.10	19G	cream											SN-008
1.20	18G	pink											SN-009

Remark: normal size in above table, we can also make special size as clients' request.

## ◆◆ Scalp Vein Sets/Safety Scalp Vein Sets

- ◆ Types:normal type and safety type
- ◆ Delicately-designed needle-point with features of sharpness,smooth puncture,less damage to the tissue,less painful feeling to the patient
- ◆ With soft wings for the convenience of fixation
- ◆ With large ID and high flow
- ◆ Size distinguished by the wing's color for the clear recognition
- ◆ Safety scalp vein set with protective sheath on the tube
- ◆ Soft pulling after the infusion so that the needle can be pulled into the protective sheath so as to prevent the medical care persons hurt by the used needle.
- ◆ Needle-hub types:1.PVC hub;2.ABS hub
- ◆ Wing types:1.Single-wing ABS;2.Double-wing PVC
- ◆ Packing types:in bulk,PE package or in blister package

◆◆ Color codes and specifications

OD (mm)	GAUGE	COLOR & CODE	LENGTH					RW	TW	BEVEL ANGLE		REF	REF FOR SAFETY TYPE
			13 1/2"	16 5/8"	20 3/4"	25 1"	28 1 1/8"			Long bevel	Short bevel		
0.40	27G	grey										01-051	SN-051
0.45	26G	brown										01-052	SN-052
0.50	25G	orange										01-053	SN-053
0.55	24G	purple										01-054	SN-054
0.60	23G	blue										01-055	SN-055
0.70	22G	black										01-056	SN-056
0.80	21G	green										01-057	SN-057
0.90	20G	yellow										01-058	SN-058
1.10	19G	cream										01-059	SN-059
1.20	18G	pink										01-060	SN-060

Remark:normal size in above table,we can also make special size as clients' request.

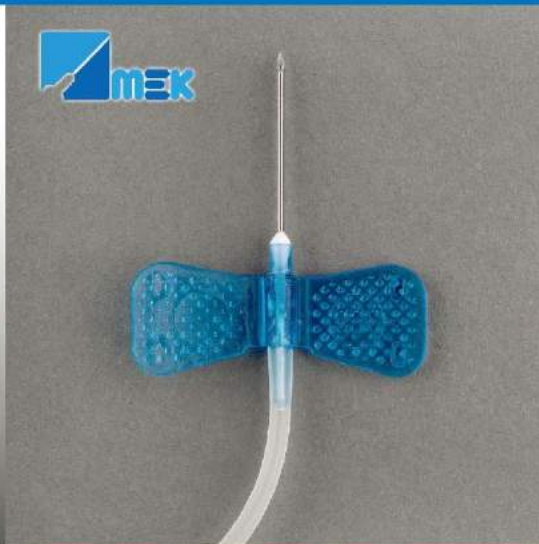



## Blood Collection (Multi-Sample) Needles

### 1. Pen type blood collection needle:(type I)

- ◆ Latex Free
- ◆ Multi-sample needles permit several samples to be taken with a single puncture
- ◆ Sharp&smooth edges make penetration painless,easy connection to rubber stoppers

### 2. Pen type(flash back) blood collection needle(type II)

- ◆ Latex Free
- ◆ Multi-sample needles permit several samples to be taken with a single puncture
- ◆ Special design can observe the vein blood flash back.

### 3. Blood collection needle with scalp vein set (type III ), Blood Collection needle with hypodermic needle(type IV)

- ◆ Latex Free
- ◆ Soft and transparent tube can observe the vein blood flow clearly.
- ◆ Double wings make puncture safe.
- ◆ Different color wings means different size.

type I type II ◆◆ Color codes and specifications

SIZE		COLOR	LENGTH			ID		BEVEL ANGLE		REF
OD (mm)	GAUGE	COLOR & CODE	20 3/4"	25 1"	38 1 1/2"	RW	TW	Long bevel	Short bevel	
0.60	23G	blue								01-101
0.70	22G	black								01-102
0.80	21G	green								01-103
0.90	20G	yellow								01-104
1.20	18G	pink								01-105

Remark:normal size in above table,we can also make special size as clients' request.

type III type IV ◆◆ Color codes and specifications

SIZE		COLOR	LENGTH				ID		BEVEL ANGLE		REF
OD (mm)	GAUGE	COLOR & CODE	16 5/8"	20 3/4"	25 1"	38 1 1/2"	RW	TW	Long bevel	Short bevel	
0.55	24G	purple									01-106
0.60	23G	blue									01-107
0.70	22G	black									01-108
0.80	21G	green									01-109
0.90	20G	yellow									01-110
0.10	19G	cream									01-111
1.20	18G	pink									01-112

Remark:normal size in above table,we can also make special size as clients' request.



## Safety Blood Collection Set

- Safety blood collection set is a new designed safety products, which connect safety scalp vein set with blood collection components. After using, push the safety protector up to lock the needle tip in to the it, which will avoid hurting nurse or patients effectively. Both with holder or without holder is ok.

Types; Safety Blood Collection Set with holder and Safety Blood collection Set without holder



### OPERATION METHOD

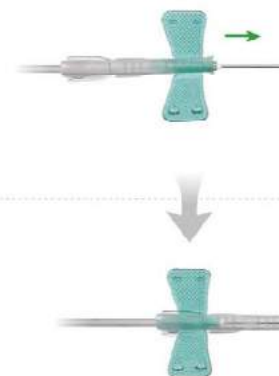

1. Push the safety cover forward over the needle after using up

2. Make butterfly part totally lock into slot of safety device

### Safety Blood Collection Set

Color codes and specifications

SIZE		COLOR	LENGTH	ID	BEVEL ANGLE		REF
OD (mm)	GAUGE	COLOR & CODE	20 3/4"	RW	TW	Long bevel	Short bevel
0.55	25G	orange					SN-101
0.60	23G	blue					SN-102
0.70	22G	black					SN-103
0.80	21G	green					SN-104

Remark: normal size in above table, we can also make special size as clients' request.

### Safety Blood Collection Set with Holder

Color codes and specifications

SIZE		COLOR	LENGTH	ID	BEVEL ANGLE		REF
OD (mm)	GAUGE	COLOR & CODE	20 3/4"	RW	TW	Long bevel	Short bevel
0.55	25G	orange					SN-105
0.60	23G	blue					SN-106
0.70	22G	black					SN-107
0.80	21G	green					SN-108

Remark: normal size in above table, we can also make special size as clients' request.

## Safety Blood Collection Needle

Safety Blood Collection Needle pen type, can be supplied with or without holder, the design of safe protector cap can shield the cannula after use, prevent needlepoint from stabbing nurse, patient or other people, which can effectively reduce infection. This kind of safety blood collection needle is a safe substitute of the general blood collection needle for clinical application.

## Intended Use

This kind of product which is used for blood collection is applicable for needle holder and vacuum tube for blood sample collection.

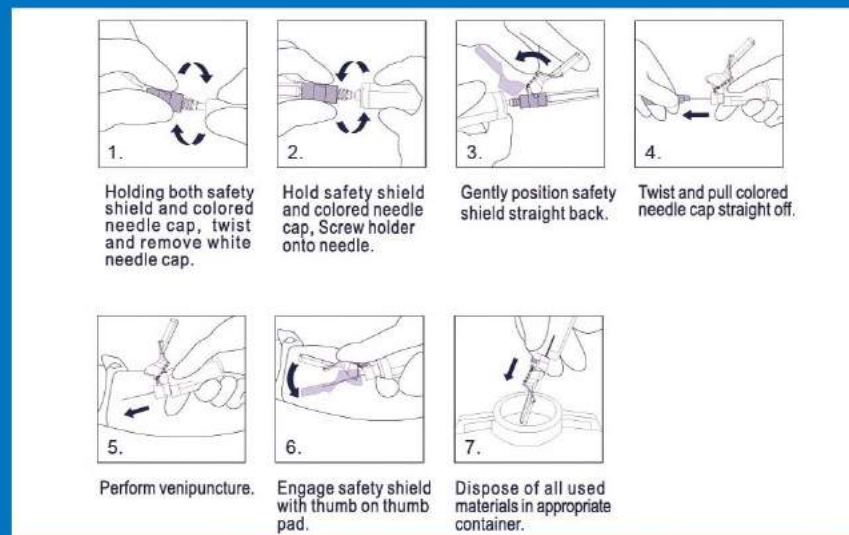
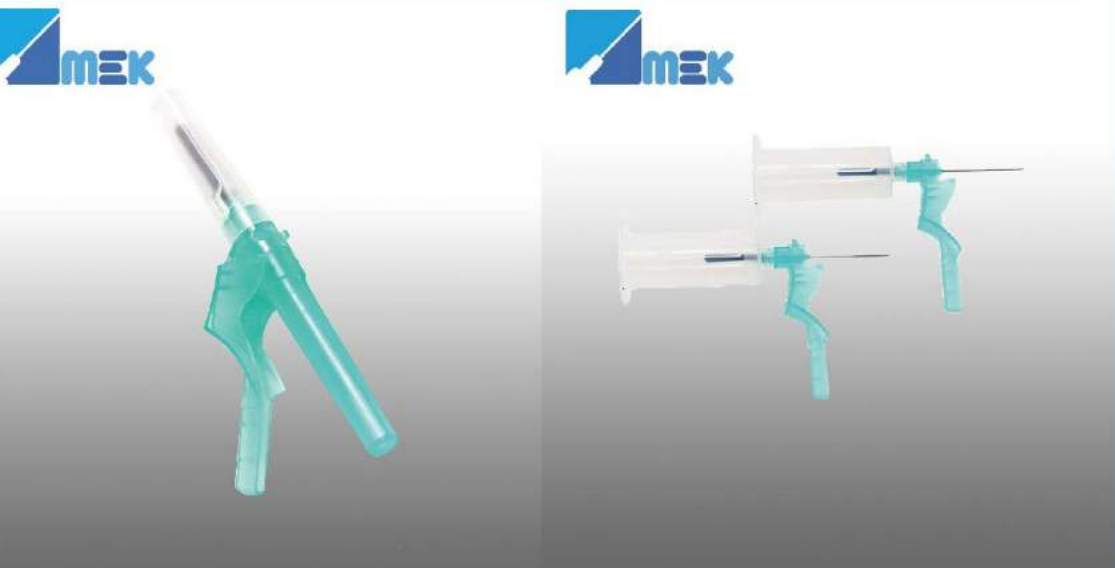

safety Blood Collection Needle

Color codes and specifications

OD (mm)	GAUGE	COLOR & CODE	LENGTH			ID		BEVEL ANGLE		REF
			20 3/4"	25 1"	38 1 1/2"	RW	TW	Long bevel	Short bevel	
0.60	23G	blue								SN-201
0.70	22G	black								SN-202
0.80	21G	green								SN-203
0.90	20G	yellow								SN-204
1.20	18G	pink								

Remark: normal size in above table, we can also make special size as clients' request.

safety Blood Collection Needle with holder

Color codes and specifications

OD (mm)	GAUGE	COLOR & CODE	LENGTH			ID		BEVEL ANGLE		REF
			20 3/4"	25 1"	38 1 1/2"	RW	TW	Long bevel	Short bevel	
0.60	23G	blue								SN-206
0.70	22G	black								SN-207
0.80	21G	green								SN-208
0.90	20G	yellow								SN-209
1.20	18G	pink								SN-210

Remark: normal size in above table, we can also make special size as clients' request.

## ❖❖ Blood collection assembly Product Safety holder

❖ Safety holder is a new designed of safety product, can be used with pen type blood collection needle to collect blood samples. There are two types; Holder with safety sheath; quicke release holder. The design is aim to avoid nurse or patient injury efficiently.

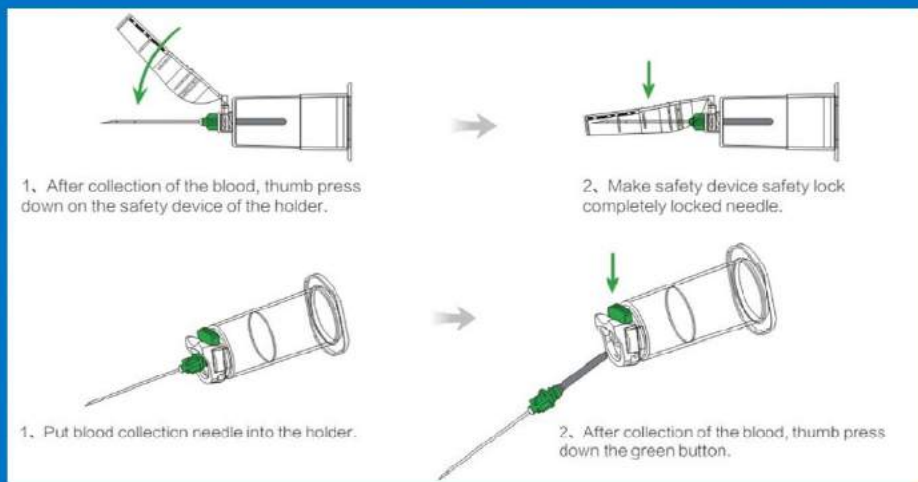
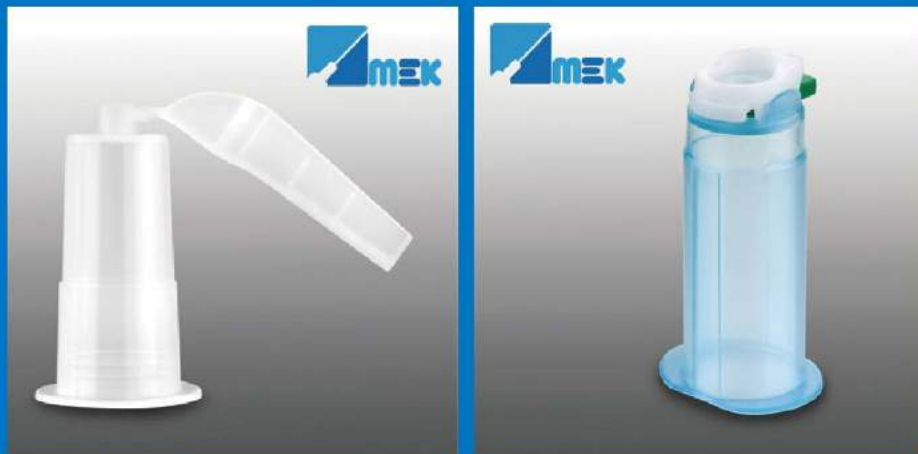

## ❖❖ Holder with luer adapter

❖ There are three types: LH001, LH002 and LH003.

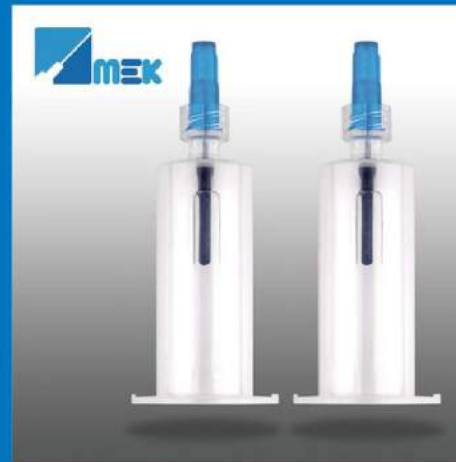

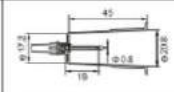
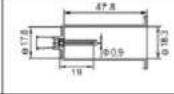
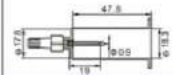
SIZE	REF	DIAGRAM
0.8 × 19	LH001	
0.9 × 19	LH002	
0.9 × 19	LH003	

## Spinal Needles

### 1. Extradural Anaesthesia needle(AN-E)

- ◆ Bend and round-smooth needlepoint can greatly reduce the risks of breaking the hard spinal theca and assure the cannula entering successfully.
- ◆ Graduation on cannula, convenient for control.
- ◆ Needle hub with wings, convenient to be hold and needles sticking into easily.

### 2. Spinal needles(AN-SI)

- ◆ Transparent hub, easy to observe the cerebrospinal fluid discharge.
- ◆ Hub with lock can keep the surface of needle bevel joint well.

### 3. Non-hurt Spinal needle(AN-SII)

- ◆ Special design for needlepoint will not hurt the hard spinal theca, close puncture hole automatically and reduce cerebrospinal fluid discharge.
- ◆ Suitable shape and location of side hole ensure enough flux, meanwhile reduce the happening of faulty retardance.

### 4. Nerve Anaesthesia needle(AN-N)

- ◆ Used for part anaesthesia, ease pain or injecting local anesthetic or first aid medication when in emergency.
- ◆ For single use only, avoid cross infection.

### 5. Pediatric anaesthesia needle(AN-X)

- ◆ Bend and round-smooth needlepoint can greatly reduce the risks of breaking the hard spinal theca and assure the cannula entering successfully.
- ◆ Graduation on cannula, convenient for control.
- ◆ Needle hub with wings, convenient to be hold and needle sticking into easily.
- ◆ Small OD, greatly reduce the hurt on pediatric patients.
- ◆ Soft tube connecting with needle hub, easily use and safety.

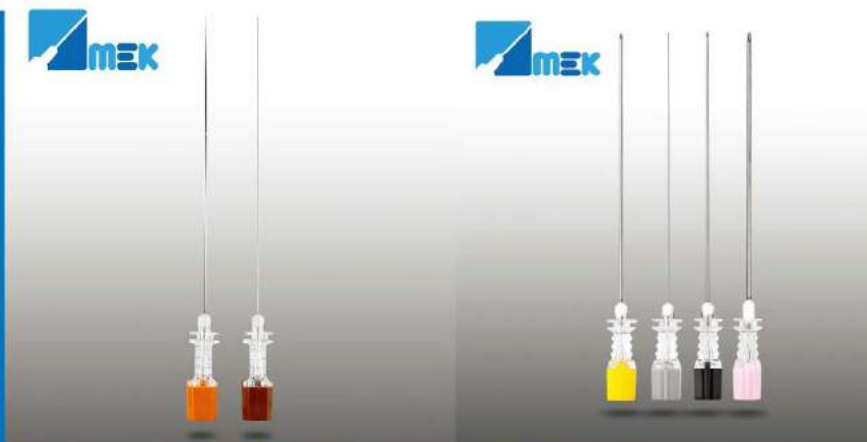

Color codes and specifications

TYPE	SIZE	COLOR & CODE	LENGTH						ID		REF
			57 2 1/4"	64 2 1/2"	80 3 1/8"	90 3 1/2"	110 4 1/2"	100 4"	RW	TW	
AN-E Extradural Anaesthesia needles	0.80 21G	green									01-301
	0.90 20G	yellow									01-302
	1.00 19G	cream									01-303
	1.20 18G	pink									01-304
	1.60 16G	white									01-305
	1.80 15G	blue-grey									01-306
AN-S I Spinal needles	0.40 27G	grey									01-307
	0.45 26G	brown									01-308
	0.50 25G	orange									01-309
	0.55 24G	purple									01-310
	0.60 23G	blue									01-311
	0.70 22G	black									01-312
	0.80 21G	green									01-313
	0.90 20G	yellow									01-314
	1.10 19G	cream									01-315
	1.20 18G	pink									01-316
AN-S II NO-hurt Spinal needle	0.50 25G	blue-grey									01-317
	0.55 24G	pale green									01-318
	0.60 23G	blue									01-319
	0.70 22G	black									01-320
	0.80 21G	green									01-321
	0.90 20G	yellow									01-322
	1.10 19G	cream									01-323
	1.20 18G	pink									01-324
	0.50 25G	orange									01-325
	0.55 24G	purple									01-326
AN-N Nerve Anaesthesia needle	0.60 23G	blue									01-327
	0.70 22G	black									01-328
	0.80 21G	green									01-329
	0.90 20G	yellow									01-330
AN-X Pediatric Anaesthesia needle	0.50 25G	orange	3/4"								01-331
	0.55 24G	purple	3/4"								01-332

Remark: normal size in above table, we can also make special size as clients' request.

## ◆◆ Epidural Needles

- ◆ Color coded hub easy for size recognition.
- ◆ Material: Quality Stainless Steel
- ◆ Core needle: Stainless Steel / Plastic available.
- ◆ Transparent hub convenient for observing outflow of cerebrospinal fluid.
- ◆ The needle tube is scaled for the purpose of depth control.

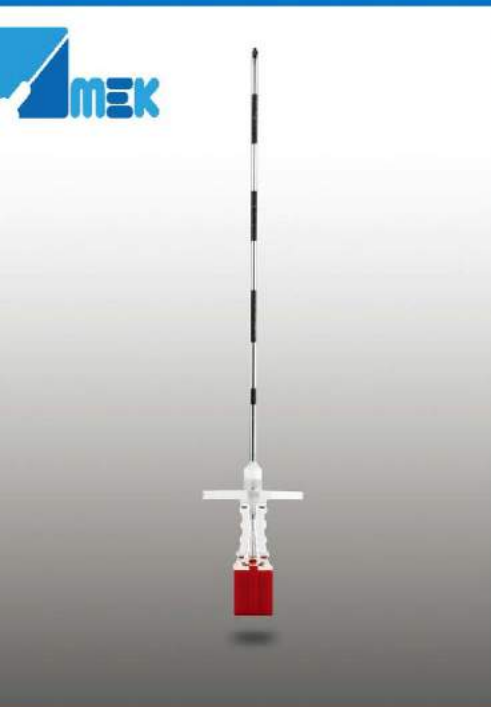

## ◆◆ Introducer Needles

- ◆ Medical grade stainless steel.
- ◆ Special designed needle hub for the convenience of operation and exact puncture
- ◆ With special designed needlepoint, doctor can control resistance freely for exact and smooth puncture
- ◆ Smooth inducing without block

◆◆ Color codes and specifications for hypodermic needle

SIZE		COLOR	LENGTH		ID		BEVEL ANGLE		REF
OD (mm)	GAUGE	COLOR & CODE	40	70	RW	TW	Long bevel	Short bevel	
0.50	25G	orange							01-801
0.55	24G	purple							01-802
0.60	23G	blue							01-803
0.70	22G	black							01-804
0.80	21G	green							01-805
0.90	20G	yellow							01-806
1.10	19G	cream							01-807
1.20	18G	pink							01-808
1.60	16G	white							01-809
1.80	15G	blue-grey							01-810

Remark: normal size in above table, we can also make special size as clients' request.



## I.V Catheter

- ◆ Easy dispenser pack
- ◆ Color-coded casing cap allows for easier identification of catheter size
- ◆ Translucent catheter hub and flashback chamber allows for easy detection of blood flashback at vein insertion
- ◆ Teflon Radio-opaque catheter
- ◆ Precision finished PTEE catheter assures stable flow and eliminates catheter tip kink during venipuncture
- ◆ Can be connected to syringe by removing filter cap to expose Luer taper end
- ◆ Use of hydrophobic membrane filter eliminates blood leakage
- ◆ Close and smooth contact between catheter tip and inner needle enables safe and smooth venipuncture
- ◆ Safety design can shield the cannula after use, preventing needlepoint from stabbing nurse ,patient or other people,which can effectively reduce infection.

### Color codes and specifications

TYPE	SIZE		COLOR & CODE	LENGTH						REF
	OD (mm)	GAUGE		20 3/4"	25 1"	32 1 1/4"	38 1 1/2"	50 2"	64 2 1/2"	
Pen type I.V-I	0.70	24G	yellow							01-201
	0.90	22G	blue							01-202
	1.00	20G	pink							01-203
	1.20	18G	green							01-204
	1.70	16G	grey							01-205
	2.0	14G	orange							01-206
Butterfly type I.V-II	0.70	24G	yellow							01-207
	0.90	22G	blue							01-208
	1.00	20G	pink							01-209
	1.20	18G	green							01-210
	1.70	16G	grey							01-211
	2.0	14G	orange							01-212
Normal/safety type I.V-III/IV	0.70	24G	yellow							01-213
	0.90	22G	blue							01-214
	1.00	20G	pink							01-215
	1.20	18G	green							01-216

Remark:normal size in above table,we can also make special size as clients' request.



## ◆◆ A.V Fistula Needles

- ◆ Fixed type, Rotating type, Safety type
- ◆ Ultra-thin wall needles allow maximum blood flow
- ◆ Ultra-sharp for easier penetration
- ◆ Siliconized for smoother, more comfortable penetration
- ◆ Easy removal of luer cap
- ◆ Double entry points on needle for quick collection
- ◆ A.V.fistula needle with safety device, can shield the cannula after use, preventing needlepoint from stabbing nurse, patient or other people, which can effectively reduce infection

### ◆◆ Color codes and specifications

TYPE	SIZE		COLOR COLOR &CODE	LENGTH			ID		REF
	OD (mm)	GAUGE		20 3/4"	25 1"	32 1 1/4"	RW	TW	
Fixed type	1.40	17G	red						01-251
	1.60	16G	green						01-252
	1.80	15G	blue						01-253
Rotating type	1.40	17G	red						01-257
	1.60	16G	green						01-258
	1.80	15G	blue						01-259

Remark: normal size in above table, we can also make special size as clients' request.





## ◆◆ Insulin Pen Needles

- ◆ Optimum treatment with maximum simplicity
- ◆ Sterile, Non-toxic, Non-pyrogenic
- ◆ Double point system
- ◆ Patient point with triple beveling for easy and atraumatic
- ◆ Cartridge point sharpened for a perfect punch with no fragmentation
- ◆ Easy flow of medication without any impurities
- ◆ Compatible with all available pen models



## ◆◆ Specifications and REF

Description	Catalog NO.
29G(0.33)×1/2" (12mm)	1-601
30G(0.30)×1/8" (4mm)	1-602
30G(0.30)×1/4" (6mm)	1-603
30G(0.30)×1/3" (8mm)	1-604
31G(0.25)×1/8" (4mm)	1-605
31G(0.25)×1/4" (6mm)	1-606
31G(0.25)×1/3" (8mm)	1-607
32G(0.23)×1/8" (4mm)	1-608

Remark: normal size in above table, we can also make special size as clients' request.



## ◆◆ Safety pen needle

- ◆ Same use steps as normal insulin pen needles, no more operation,
- ◆ automatically achieve the function of protecting needle tip after use
- ◆ Match with normal insulin pen in market
- ◆ Pain-release triple bevel needle tip design, large flow thin wall cannula
- ◆ Available size: 30G/31G with length 5mm, 6mm and 8mm



## ◆◆ Huber Needles

### ◆◆ Structure and composition:

- ◆ The huber needles are assembled by protective cap, needle hub, needle tube, tubing, injection site, robert clamp and other parts. All materials meet medical requirement, sterilized by ETO, pyrogen-free.

### ◆◆ Material:

- ◆ PC, PP, PVC, SUS304 Stainless Steel Cannula, Silicone oil

### ◆◆ Intended use:

- ◆ The huber needle is intended to be used to feed medicine to the device implanted in patient hypoderm.

### ◆◆ Types:

- ◆ Huber needle with wing: with Y port and without Y port
- ◆ Huber needle with air-vent hub
- ◆ Huber needle with disposable needle: Straight huber needle, 90 degree curved huber needle

Huber needle with wing

#### ◆◆ Color codes and specifications

OD (mm)	GAUGE	COLOR & CODE	LENGTH								ID		BEVEL ANGLE		REF
			8 1/3"	13 1/2"	16 5/8"	20 3/4"	25 1"	32 1 1/4"	38 1 1/2"	50 2"	RW	TW	Long bevel	Short bevel	
0.70	22G	black													01-951
0.80	21G	green													01-952
0.90	20G	yellow													01-953
1.10	19G	cream													01-954

Remark: normal size in above table, we can also make special size as clients' request.

Huber needle with disposable hub

#### ◆◆ Color codes and specifications

OD (mm)	GAUGE	COLOR & CODE	LENGTH								ID		BEVEL ANGLE		REF
			8 1/3"	13 1/2"	16 5/8"	20 3/4"	25 1"	32 1 1/4"	38 1 1/2"	50 2"	RW	TW	Long bevel	Short bevel	
0.40	27G	grey													01-955
0.45	26G	brown													01-956
0.50	25G	orange													01-957
0.55	24G	purple													01-958
0.60	23G	blue													01-959
0.70	22G	black													01-960
0.80	21G	green													01-961
0.90	20G	yellow													01-962
1.10	19G	cream													01-963
1.20	18G	pink													01-964



## Micro Cannula for Fillers

- ◆ Made of high quality stainless steel
  - ◆ Different size available
  - ◆ Sterile package
  - ◆ Special design is available
  - ◆ Round tip and hole to avoid any damage
- With graduation or without graduation

### Specifications

SIZE		COLOR	LENGTH			REF
OD (mm)	GAUGE	COLOR & CODE	1"	1 1/4"	1 1/2"	
1.20	18G	pink				01-901
0.90	20G	yellow				01-902
0.70	22G	black				01-903
0.50	25G	orange				01-904
0.40	27G	grey				01-905
0.30	30G	lightyellow				01-906

Remark:normal size in above table,we can also make special size as clients' request.

## Mesotherapy needle

- ◆ Made of high quality stainless steel
- ◆ With large ID and high flow
- ◆ Delicately-designed needle-point with features of sharpness, smooth puncture, less damage to the tissue, less painful feeling to the patient
- ◆ Size distinguished by the needle-hub's color for thr recognition
- ◆ Sterilized: by EO

### Color codes and specifications

SIZE&LENGTH		COLOR	LENGTH				REF
OD(mm)	GAUGE	COLOR & CODE	4mm	6mm	8mm	12mm	
0.4	27G	Grey	√	√	√	√	MN -001
0.3	30G	Light yellow	√	√	√	√	MN -002
0.25	31G	White	√	√	√	√	MN -003
0.23	32G	Green	√	√	√	√	MN -004
0.21	33G	Black	√	√	√	√	MN -005
0.18	34G	Orange	√	√	√	√	MN -006



## ❖❖ Hair transplant needle

### ❖❖ Structure and composition:

- ◆ The Hair transplant needle consist of needle hub, needle tube, Protective cap. All materials meet medical requirement, sterilized by ETO, pyrogen free.

### ❖❖ Material:

- ◆ PP, SUS304 Stainless Steel Cannula, Silicone oil

### ❖❖ Intended use:

- ◆ The Hair transplant needle is used for single hair follicle transplantation. The hair follicle is directly inserted into the skin for implantation.

### ❖❖ Specifications:

- ◆ 0.6mm,0.8mm,1.0mm,1.2mm

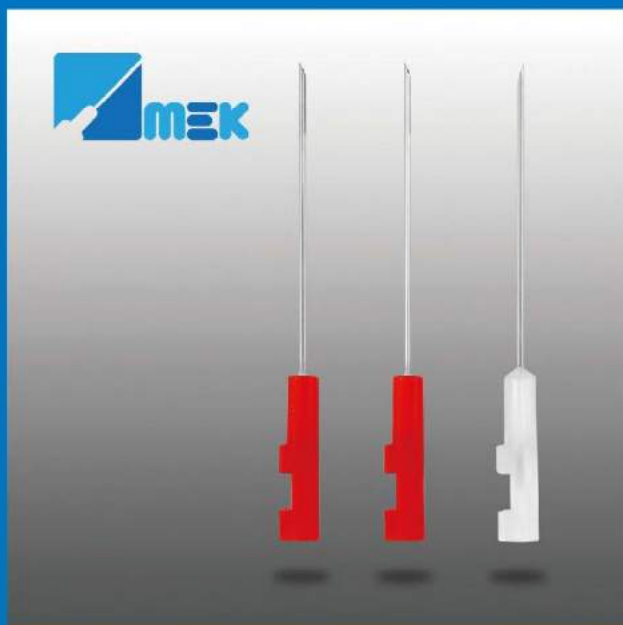

## ❖❖ Low Dead Space Needle

- ◆ Low Dead Space needles may help to reduce the risk of blood borne virus transmission by significantly reducing the dead space in a syringe, therefore minimising exposure to potentially contaminated blood fluid.



## ◆◆ Veress Needle

- ◆ Veress Needles are designed for the safe, simple, effective creation of the pneumoperitoneum.
- ◆ Big size spring-loaded stylet provides loud audible "click" when passing through tissue layers
- ◆ Visible red indicator of needle position
- ◆ Sharp tip for easy insertion
- ◆ High flow stopcock
- ◆ Two sizes with 120/150mm length are available

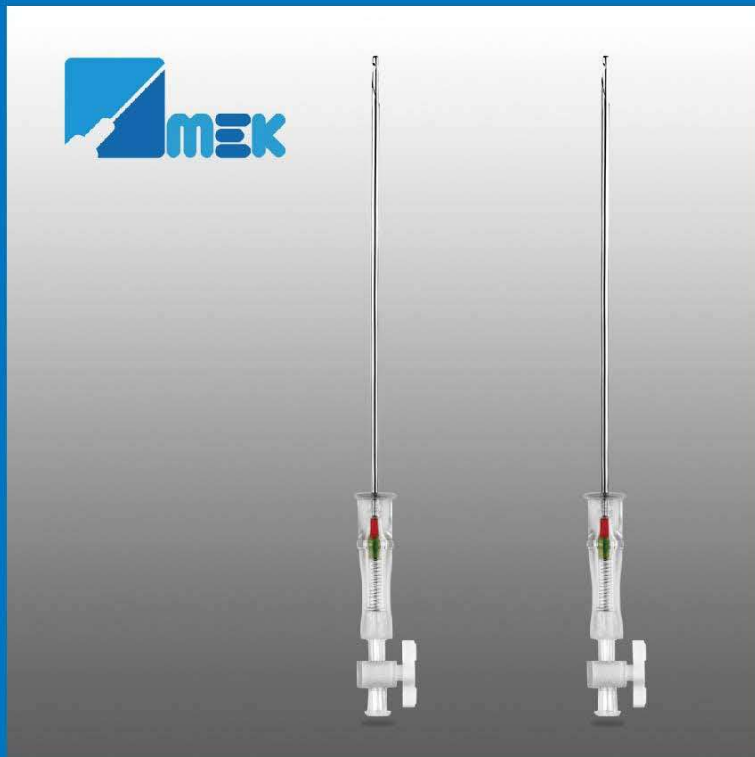

## ◆◆ Biopsy Needle

- Echogenic and atraumatic needle tip design
- Light weight handle
- Adjustable sample notch: 10mm-20mm
- Depth marked canula
- Color code
- Co-axial needles are optionally available

GAUGE	LENGTH	COLOR
14G	100 · 150 · 200 · 250mm	PALE GREEN
16G	100 · 150 · 200 · 250mm	WHITE
18G	100 · 150 · 200 · 250mm	PINK



## ◆◆ Chiba Needles

- ◆ Depth marker that stays where you put it
- ◆ Locking hub for ease of handling, no stylet and cannula separation until you want it
- ◆ Depth marks etched on cannula
- ◆ Palpable alignment markings on hub for easy orientation

### ◆◆ Color codes and specifications

SIZE		COLOR	LENGTH				REF
OD (mm)	GAUGE	COLOR & CODE	4.0"	4.5"	6"	8"	
1.20	18G	pink					01-820
0.90	20G	yellow					01-821
0.70	22G	black					01-822
0.50	25G	orange					01-823
0.40	27G	grey					01-824
0.30	30G	lightyellow					01-825

Remark: normal size in above table, we can also make special size as clients' request.

## ◆◆ Bone Marrow Biopsy Needles

- ◆ Special Trocar needle and sharp tubing ensure minimal invasion.
- ◆ 5 side holes at front end of tubing, multi-way collect bone marrow, more efficient and less pain.
- ◆ Human ergonomics handle, comfortable and easy operation.
- ◆ Provide one more needle, ensure sharpness and less pain when multi-point invasion.

### ◆◆ Specifications

		COLOR	LENGTH				REF
OD(mm)	SIZE	COLOR & CODE	2 3/4"	3 1/2"	4 1/4"	5"	
4.20	8G						01-880
3.40	10G						01-881
3.00	11G						01-882
2.50	13G						01-883
1.80	15G						01-884

Remark: normal size in above table, we can also make special size as clients' request.

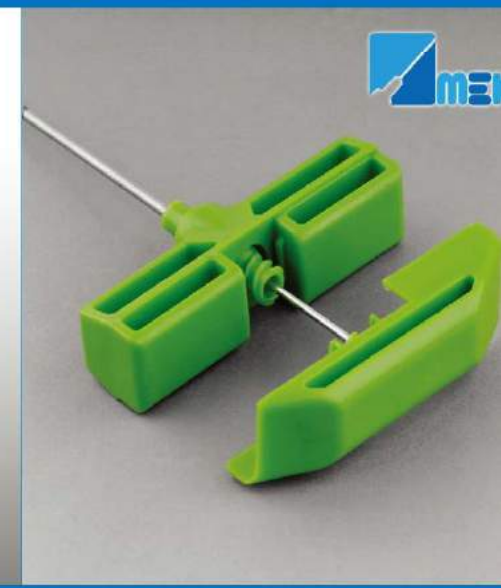
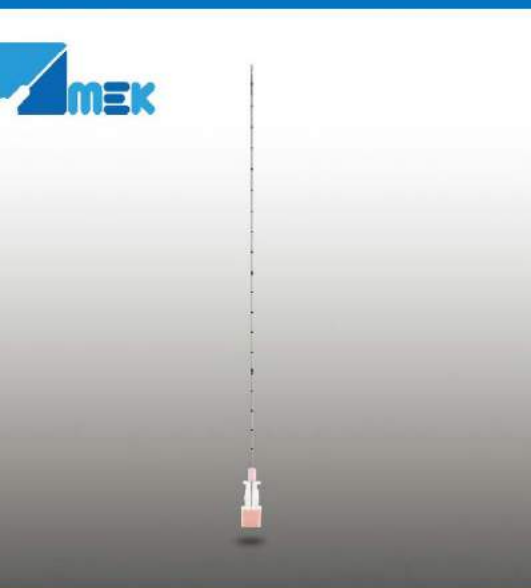

## Blunt Fill Needle & Blunt Filter Needle

- ◆ Filter needles feature a molded-in filter membrane for reliable performance
- ◆ They reduce particulates larger than five microns when aspirating, reconstituting and transferring fluids or when withdrawing medication from glass reservoirs

### Specifications

SIZE		COLOR	LENGTH	REF
OD (mm)	GAUGE	COLOR & CODE	1 1/2"	
1.20	18G	orange		01-920
1.10	19G	brown		01-921

Remark: normal size in above table, we can also make special size as clients' request.

## Irrigation needle

- ◆ Multi angle bended, easy for cleanout, can be used for different occasion.
- ◆ Different type, client can choose products according to irrigation part.



## Dental irrigation needle

- ◆ Made of high quality stainless steel.
- ◆ Blunt end, soft needle .straight or Pre-Bent Tips resists crimping.
- ◆ Universal luer lock style hub.
- ◆ Extended 3/4" length to reach pockets, fistulas and surgical sites.
- ◆ Different color Hub to identify different gauge.
- ◆ Sterilized by EO, non-toxic, non-pyrogenic.

### Color codes and specifications

SIZE	COLOR	LENGTH			REF	
		GAUGE	1"	1 1/2"		1 1/2"
1.20	18G	pink				01-840
0.90	20G	yellow				01-841
0.70	22G	black				01-842
0.50	25G	orange				01-843
0.40	27G	grey				01-844
0.30	30G	lightyellow				01-845

Remark: normal size in above table, we can also make special size as clients' request.

## Dental Needles

- ◆ Made of high quality stainless steel
- ◆ Different needle bevels to meet different injection requirements
- ◆ Size distinguished by the hub's color for the clear recognition
- ◆ Different size available
- ◆ Production of all kinds of special needles required by our customers

### Color codes and specifications

SIZE	COLOR	LENGTH	ID	BEVEL ANGLE		WORM TYPE	REF
				Long bevel	Short bevel		
0.30	30G	13 1/2"	16 5/8"	25 1"	32 1 1/4"	38 1 1/2"	01-401
							01-402
0.40	27G						01-403
							01-404
0.50	25G						01-405
							01-406

Remark: normal size in above table, we can also make special size as clients' request.





## Cannulas

Standard biopsy



Crown core cut



Franseen style



Epidural points(Touhy)



Spinal points

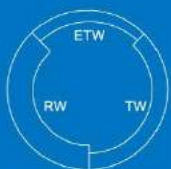

Comparison between Regular Wall, Thin Wall and Extra Thin Wall



Long bevel



Short bevel

GAUGE	Size		Outer diameter		Inner diameter		
	Nominal		Min	Max	Regular wall min	Thin wall min	Extra thin wall min
31G	0.25		0.254	0.267	0.114	0.125	
30G	0.30		0.298	0.320	0.133	0.165	
29G	0.33		0.324	0.351	0.133	0.190	
28G	0.36		0.349	0.370	0.133	0.190	
27G	0.40		0.400	0.420	0.184	0.241	
26G	0.45		0.440	0.470	0.232	0.292	
25G	0.50		0.500	0.530	0.232	0.292	
24G	0.55		0.550	0.580	0.280	0.343	
23G	0.60		0.600	0.650	0.317	0.370	0.480
22G	0.70		0.698	0.730	0.390	0.440	0.522
21G	0.80		0.800	0.830	0.490	0.547	0.610
20G	0.90		0.860	0.920	0.560	0.635	0.687
19G	1.10		1.030	1.100	0.648	0.750	0.850
18G	1.20		1.200	1.300	0.790	0.910	1.041
17G	1.40		1.400	1.510	0.950	1.156	1.244
16G	1.60		1.600	1.690	1.100	1.283	1.390
15G	1.80		1.750	1.900	1.300	1.460	1.560
14G	2.10		1.950	2.150	1.500	1.600	1.727
13G	2.40		2.300	2.500	1.700	1.956	
12G	2.70		2.650	2.850	0.950	2.235	
11G	3.00		2.950	3.150	2.200	2.464	
10G	3.40		3.300	3.500	2.500	2.819	



Trocar tip



Closed tip



Widened ends



Marking



Embossed



Trocar tip



Ends sandblasted



Reduced ends



Ground holes



Lateral drilled holes



### ◆◆ Special Plastic Needle

All of the needle is plastic, without any metal material, special design for special use.



### ◆◆ Polycarbonate Syringe

- ◆ Polycarbonate syringe barrels create a "smooth as glass" feel and help increase the visualization of fluid and air bubbles.
- ◆ Different colors to meet different choice
- ◆ Multiple Sizes: 1, 2, 3, 6, 10, 20, 30 & 60ml
- ◆ Customized Printing: All medication names can be printed directly on the syringe barrel in white or black ink.
- ◆ Luer Options: Fixed Male Luer or Slip Luer



## ❖❖ Syringe/Safety Syringe

- ◆ The Syringe/safety syringe (with/without needle, needle can be normal or safety) are assembled by barrel, plunger, piston, with/without hypodermic needles, which can be classified to central nozzle type and side nozzle type according to the prick connector. It has three parts and two parts according to structure. All parts and material for this product meet medical requirements, after sterilized by ETO, pyrogen free.
- ◆ Different size, meet different requirements.
- ◆ Central luer slip/central luer lock/eccentric luer slip.
- ◆ Special design to prevent plunger slipping out.
- ◆ Latex/ latex free piston.
- ◆ W/needle, W/O needle.
- ◆ Custom needle size per specification.

Detailed specifications

SIZE	SLIP REF	LOCK REF	ECCENTRIC REF
1ml	02 - 101	02 - 112	/
2ml	02 - 102	02 - 113	/
3ml	02 - 103	02 - 114	/
5ml	02 - 104	02 - 115	/
10ml	02 - 105	02 - 116	02 - 123
20ml	02 - 106	02 - 117	02 - 124
25ml	02 - 107	02 - 118	02 - 125
30ml	02 - 108	02 - 119	02 - 126
35ml	02 - 109	02 - 120	02 - 127
50ml	02 - 110	02 - 121	02 - 128
100ml	02 - 111	02 - 122	/

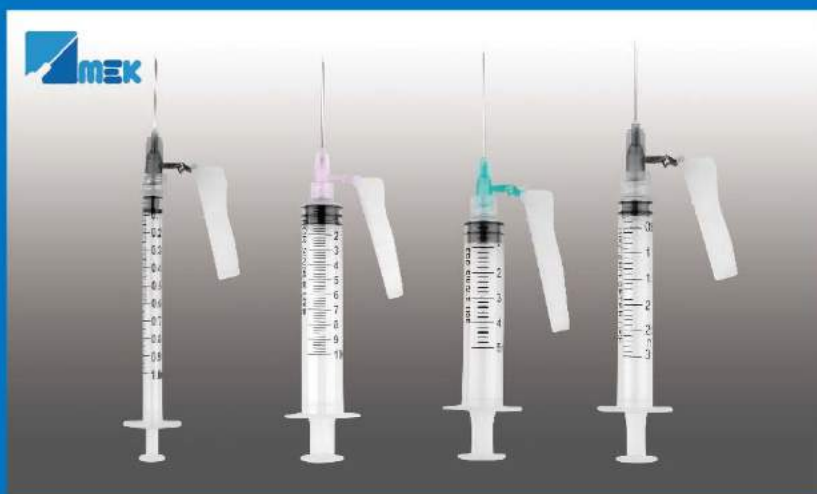

## ❖❖ Insulin Syringe

- ◆ The Insulin Syringe are assembled by needle protective cap, needle tube, barrel, piston, plunger, protective cap. All parts and materials used in this can meet medical requirement. Sterilized by ETO, pyrogen-free. It is applicable injection after taking out insulin. According to the size, it can be specified to: U-40, U-100.
- ◆ The high transparency of the barrel permits the end user a strict control on the foreign substance and liquid flow.
- ◆ The inerasable graduation permits an easy reading, 40 unites and 100 unites are available.
- ◆ The medical grade silicon oil is used as the lubricant the purpose of getting a smooth plunger movement.
- ◆ Sterilized by EO gas, non-toxic, non-pyrogenic, single use only.
- ◆ Material for barrel and plunger: medical grade PP
- ◆ Material for gasket: natural rubber/latex-free

Detailed specifications

I.U.	COLOR	NEEDLE SIZE	REF
U - 40	Red	29G	02 - 601
		30G	02 - 602
		31G	02 - 603
U - 100	Orange	29G	02 - 604
		30G	02 - 605
		31G	02 - 606

Normal size in above table, we can also make special size as client's request.



## ◆◆ Enteral Syringe

The Enteral syringe is used for delivering drug or food to oral or enteral

### ◆◆ Structure and composition:

- ◆ The Enteral syringe are assembled by Barrel, Plunger, Piston. All parts and material for this product meet medical requirements, after sterilized by ETO.

### ◆◆ Material:

- ◆ PP, Isoprene rubber, Silicone oil

### ◆◆ Specifications:

- ◆ 1ml,3ml,5ml,10ml,20ml,60ml,100ml

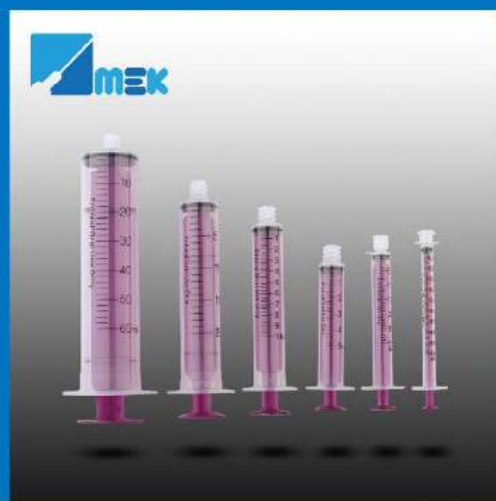
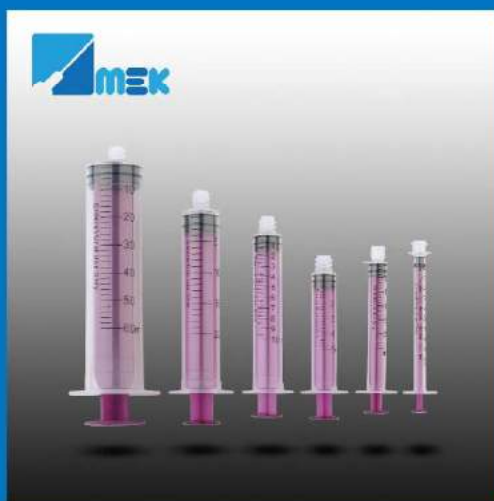

## ◆◆ Oral Syringe

Oral syringe for single use are intended for oral administration of drugs.

### ◆◆ Structure and composition:

- ◆ The oral syringe are assembled by Barrel, Plunger, Piston. All parts and material for this product meet medical requirements, after sterilized by ETO.

### ◆◆ Material:

- ◆ PP, Isoprene rubber, Silicone oil

### ◆◆ Specifications:

- ◆ 1ml,3ml,5ml,10ml,20ml

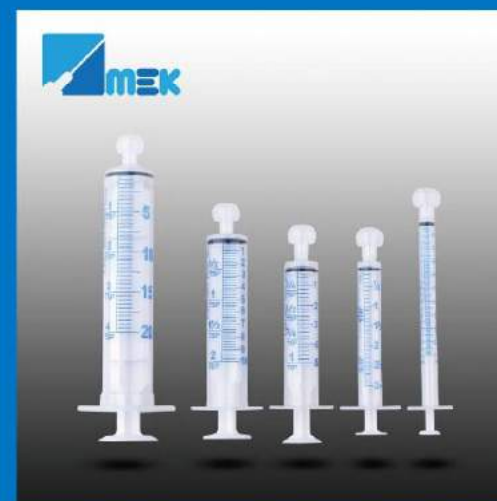

## NR-fit Syringe

### Structure and composition:

- The NR-fit syringes are assembled by Barrel, Plunger, Piston. All parts and material for this product meet medical requirements, after sterilized by ETO, pyrogen free.

### Material:

- PP, Isoprene rubber, Silicone oil



## Anaesthesia Needles

### Structure and composition:

- The Anaesthesia needles consist of needle hub, needle tube(inner), protector cap. Major categories: Spinal anesthesia needles, Epidural anesthesia needles, Combined anesthesia needles.

### Material:

- PP, PC, ABS, SUS304 Stainless Steel Cannula, Silicone Oil.

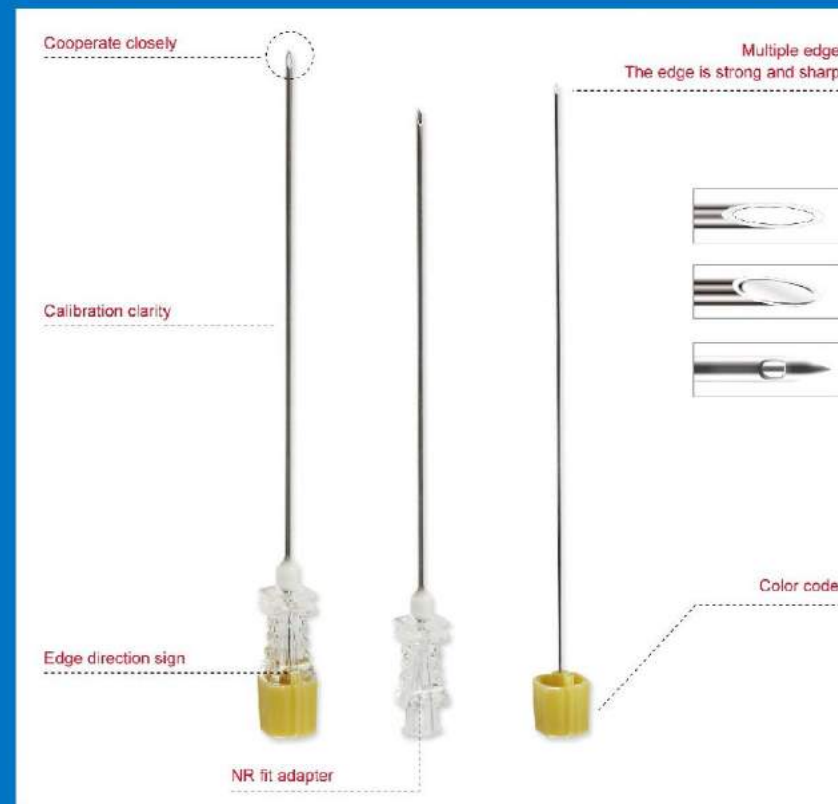

## ◆◆ NR-fit Stopcocks

### ◆◆ Structure and composition:

- ◆ The NR-fit Stopcocks are assembled by stopcock body, Locking screw. All parts of this product and processing of materials are used in line with requirements of medical materials, after sterilized by EO, pyrogen free.

### ◆◆ Material:

- ◆ PCTG, HDPE



## ◆◆ NR-fit Extension Sets

### ◆◆ Structure and composition:

- ◆ The NR-fit Extension sets are assembled by NR-fit adapter, Robert lock clamp, tube. All parts of this product and processing of materials are used in line with the requirements of medical materials, after sterilized by EO, pyrogen free.

### ◆◆ Material:

- ◆ PCTG, PVC, POM/HDPE.

