

# 32A2P Modular Contactor



Current level: 16A 20A 25A 32A

Contact form: 1NO / 1NC / 2NO / 2NC / 1NO1NC

## Main parameter and technical performance

Power circuit		
Voltage rating(Ue)		250V AC
Frequency		50/60Hz
Endurance(O-C)		1,000,000 cycles
Electrical		100,000 cycles
Maximum number of switching operation a day		100
Insulation voltage(Ui)		500 V AC
Pollution degree		2
Rated impulse withstand voltage(Uimp)		2.5kV(4kV for 12/24/48VAC)
Degree of protection (IEC 60529)	Device only	IP20
	Device in modular enclosure	IP40
Operating temperature		-5°C~+60°C
Storage temperature		-40°C~+70°C
Tropicalization(IEC 60068.1)		Treatment 2 (relative humidity 95% at 55°C)

ELSV compliance(Extra Low Safety Voltage)for 12/24/48vac versions

The product control conforms to the SELV(safety extra low voltage)requirements

(1)In the case of contactor mounting in a enclosure for which the interior temperature is in range between 50 °C and 60 °C,it is necessary to use a spacer, between each contactor

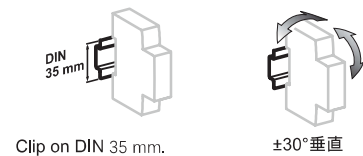

Clip on DIN 35 mm.

±30°垂直

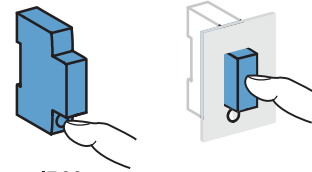

IP20

IP40

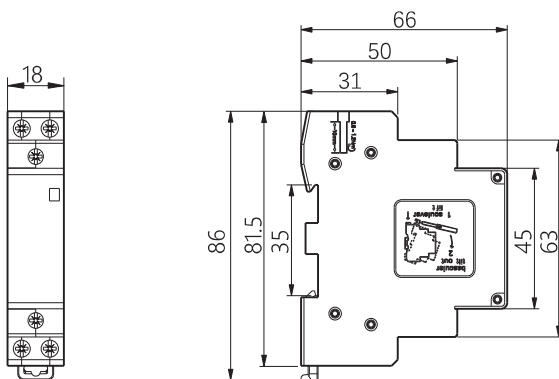
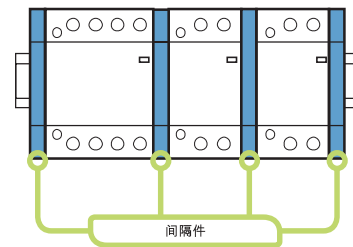

BMC1-16/20/25/32A Modular Contactor